

# Orange Village Recycling Calendar 2024



# VILLAGE DIRECTORY

## EMERGENCY.....911 (24 Hours)

### Police Non-Emergency

Monday - Friday 8:00 a.m. - 4:00 p.m. (440) 498-4401

After Normal Business Hours (440) 247-7321

### Fire Non-Emergency

8:00 a.m. - 8:00 p.m. (440) 498-4402

After Normal Business Hours (440) 247-7321

Village Hall

4600 Lander Road

Phone: (440) 498-4400

Fax: (440) 498-4404

Service Department

4680 Lander Road

Phone: (440) 498-4403

Fax: (440) 287-5067

Building Department

4680 Lander Road

Phone: (440) 498-4405

Fax: (440) 287-5150

Website: [www.orangevillage.com](http://www.orangevillage.com)

## SERVICES OFFERED TO OUR RESIDENTS

Orange Village offers a wide array of amenities and services to our residents. Most services are free. If there is a fee or deposit associated with the service, it will be noted. Contact the appropriate department for more information.

### Administration/Service Dept. 440-498-4400

- Paper Shredding Events
- Branch Chipping
- Leaf Collection
- Flag, Computer, Tire, Household Hazardous Waste Collection
- Orange C.A.R.E.S. (Caring About Residents - Encouraging Service)
- Pavilion (Refundable Deposit)/Baseball/Soccer Field Rental
- Container/Dumpster Rental (Fee) - April through October

### Fire Dept. 440-498-4402

- CPR/First Aid & AED Class
- Smoke Detector Installation Assistance
- Home Safety Evaluation
- Fire Department Tours
- Residential Lock Box (Deposit)

### Police Dept. 440-498-4401

- Car Seat Installation
- Orange C.A.R.E.S. Calls - Phone Call/Welfare Check
- Fingerprinting (Must bring fingerprint card)
- Prescription Drug Disposal
- Vacation Watch
- Rape, Aggression, Defense (RAD) Training
- Law Enforcement Explorer Program

### Park Amenities

- Playground (2023 Parent Choice Award Runner Up)
- Dog Park
- Park Trails connecting to Recreational Trails
- Pickleball Courts
- Baseball/Soccer Fields

We are pleased to provide you with our 2024 Orange Village Recycling Calendar filled with recycling tips and opportunities. Orange Village received a grant from the Cuyahoga County Solid Waste District for the printing of this informative calendar.

Recycling has certainly changed over the years. We began by recycling paper and cardboard at dropoff bins. We progressed to blue bags and small containers for certain items. Currently we are able to commingle all the recyclable items in 64 gallon recycle containers. Items that we are able to place in the container are constantly changing. This calendar provides a great deal of information including what items can be recycled in your container and what items cannot be placed in your recycle container. Please note that all information stated in the calendar was correct at the time of printing and may be subject to change. We will keep you updated on new information via our electronic newsletters, please sign up on our website.

As always, I continue to encourage all residents to recycle as much as possible, not only in your recycle container but also with composting bins, grasscycling and repurposing of items. We also offer a metal recycle container at Orange Village Service Department (by the salt shed) for ferrous and non-ferrous metals. The container is marked with a sign under the overhang. It is for "Metals only" - no other trash or products. This program allows us to reduce landfill costs and save the environment.

In 2022, Orange Village residents diverted over 310 tons of recyclable materials from the landfill. This effort not only helped the plant but saved the Village over \$10,000. Please be vigilant with recycling and strive to make 2024 a great recycling year. Everyone reaps the long-term benefits of recycling.

Please visit our informative website, [www.orangevillage.com](http://www.orangevillage.com), to sign up for our bi-monthly electronic newsletter (Enews), CodeRed for emergency and general notifications via phone, text and email, access meeting minutes and video recordings of Council meetings, view changes to items that are recyclable, and view monthly Tax Administrator and Treasurer reports. This is only a few of the many items that can be found on our website. We urge you to stay informed of all the wonderful happenings in Orange Village throughout the year.

Thank you for your efforts to reduce, reuse and recycle our planet's resources.

Sincerely,

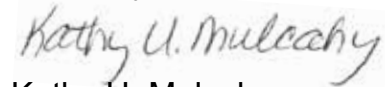

Kathy U. Mulcahy  
Mayor (1996-2023)



## Container Rental Service Offered

Orange Village will drop off a 6, 8, 10 or 12 yard container during the months of April through November (weather permitting) to help dispose of brush, yard waste, construction debris or household debris. You



cannot mix items in the container but you can choose from several different types of materials to dispose of. Rental costs vary depending on container size and items to be discarded.

Please visit our website at [www.orangevillage.com](http://www.orangevillage.com) or call us at 440-498-4403 for more information.

## Curbside Refuse and Recycling Collection

Orange Village provides weekly curbside collection of refuse and recyclables through our contract with Kimble Recycling & Disposal, Inc. All material is collected from your home on the same day.

Collection for Orange Village is on **Monday** except when certain holidays fall on a Monday, then collection will take place on Tuesday. Below is a list of holidays that will change our collection day:

• **New Year's Day, Monday, January 1**

• **Memorial Day, Monday, May 27**

• **Labor Day, Monday, September 2**

Pick up will be: • **Tuesday, January 2**

• **Tuesday, May 28**

• **Tuesday, September 3**

### Ordinance 939.02

- Refuse and recyclables ***must be placed on the tree lawn near the street before 7:00 a.m. on the day of collection.***
- Containers must not be placed curbside prior to 4:00 p.m. on the day before any scheduled collection day.
- All containers must be removed from the curbside prior to 10:00 a.m. the day after any scheduled collection day.
- All perishable trash placed curbside should be placed in a container which is not susceptible to being opened or destroyed by animals.

### Placement of Your Refuse and Recycling Containers

Please place your containers 2 feet from the street with the lid opening facing the street and 3 feet from other objects. Please place your recycling on one side of your driveway and trash can on the other. We have noticed that some residents are not placing their cans out prior to **7:00 a.m.** on Monday mornings. It is imperative that you place your cans out on time. The pickup route for Kimble has been known to change from week to week.

**If you have a new home, please contact Village Hall at 440-498-4400 to establish service and schedule delivery of your containers.**



## ASSISTANCE WITH PLACING YOUR CANS AT THE STREET



If you have difficulty taking your trash and recycle containers to the street on a weekly basis and are willing to pay a nominal fee to have this accomplished, please contact Anna Girardi at 440-287-5131. Orange Village has the names of vendors that provide this service, for a fee. The Village does not endorse or investigate any company that offers this service. We will provide the vendor information to the resident. If any party desires to provide this service for a fee, please contact Anna Girardi.

Visit our website at [www.orangevillage.com](http://www.orangevillage.com) for more information on recycling and other Village services.

## Curbside Recycling...

Please rinse all containers to remove residue

### Materials Accepted for Curbside Recycling Include:

#### RECYCLE THESE IN YOUR RECYCLE CONTAINER

##### ALUMINUM CUPS



Empty and Rinse  
No Straws

##### CANS



Empty and Rinse

##### GLASS BOTTLES & JARS



Empty and Rinse

##### PAPER & BOXES



Flatten Cardboard

##### PLASTIC BOTTLES & JUGS



Empty and Rinse  
Replace Cap

#### Paper and Boxes

Newspaper, Magazines, Mail (no glossy paper)  
Corrugated cardboard  
Telephone books  
Printer/copier paper (not shredded)  
Chipped board (cereal boxes)

#### Bottles and Containers

Aluminum and steel cans  
Cartons  
Glass bottles and jars  
Plastic beverage bottles and jugs, caps on (*only with an opening or neck narrower than the body*)  
Laundry, shampoo and soap containers, caps on

### Materials NOT Accepted in the Recycling Container

#### Cardboard and Paper

Frozen food containers  
Paper plates, towels, napkins  
Wax coated boxes

#### Glass

Ceramics  
Drinking glasses  
Light bulbs - All  
Mirrors  
Window glass

#### Household Items

Hangers/clothes  
Pots, pans/bakeware  
**Styrofoam®**



#### Paint Cans/Motor Oil Containers

#### Plastics

##### Plastic grocery bags

Bulky plastics (toys, buckets)  
Clamshell containers (produce, take-out items)  
Egg cartons  
Yogurt containers  
Utensils



#### Shredded Paper

#### Yard Waste

#### Miscellaneous Items

Aluminum Foil/Pans  
Automotive parts  
Batteries  
Hoses  
**Needles \*DO NOT place needles in the recycle container, see May for disposal information\***  
Outdoor plastic furniture  
PVC piping  
Pallets  
Plastic toys  
Vinyl siding  
Wood



## Holiday Tree Recycling

Orange Village Service Department will be collecting your natural holiday trees on January 2, 8, 16, and 22. The trees will be chipped instead of using valuable space in the landfills. Please prepare your tree for collection by following these simple guidelines:

- \* Place tree with trunk facing the road.
- \* Remove lights, ornaments, tinsel and other trimmings from branches.
- \* Remove tree stands, metal or wood.
- \* Do not bag your tree.



## Recycle Your Holiday Lights



Did you find strings of holiday lights that are old or no longer working? Orange Village Service Department will accept them on January 5 and 12, from 7:00 a.m. to 3:00 p.m. Drop off your old lights, power strips and power cords at the Orange Village Service Department Recycle Center, 4680 Lander Road, to be recycled. **DO NOT PLACE THEM IN YOUR CURBSIDE RECYCLE CONTAINER!**

## Household Hazardous Waste, Escrap and Flags: First Friday of Every Month (7am to 3pm)

Orange Village Service Department will accept unwanted oil-based paint, pesticides, automotive fluid and other hazardous products found in your home as well as computer equipment and retired American flags. You can tell if a product is hazardous if words such as POISON, DANGER, WARNING and CAUTION appear on the label.

**Antifreeze** - If you are connected to a sanitary sewer, antifreeze may be diluted with water and flushed down an inside utility drain. Do not use an outside storm drain. ***If you use a septic system, do not flush antifreeze down any drain.*** It may be included in the household hazardous waste collection.

**\*How to decide if you have latex paint:** Look for "latex" on the label. If the paint is cleaned up with water, it is latex and can be disposed of in your regular trash collection as long as it is solidified first. See May for information on how to solidify the paint.

### Household Materials that are accepted:

- Oil or solvent-based paint , sealers, primers (**\*Latex paint will not be accepted\*** - see June for latex paint disposal)
- Adhesives
- Aerosol cans
- Antifreeze
- Bleaches
- Cleaners/Acids
- Fertilizers
- Gas/Kerosene/Lighter Fluid
- Mercury Items (thermometers, thermostats, etc.)
- Motor Oil/Greases/Fryer Oil
- Pesticides/Herbicides
- Pool Chemicals
- Roof Coatings/Sealers
- Stains/Varnishes
- Turpentine/Thinners
- Wood Preservatives



Visit our website at [www.orangevillage.com](http://www.orangevillage.com) for more information on recycling and other Village services. Sign up for our electronic newsletter (enews) for bi-monthly updates.



## Paper Shredding Events

**February 9, June 7 and October 18 from 9 a.m. - noon\***  
**at Orange Village Service Department, 4680 Lander Road**

**April 26, August 16 and December 13 from 9 a.m. - noon\***  
**at Pepper Pike City Hall, 28000 Shaker Blvd.**



Orange Village, in cooperation with the City of Pepper Pike, will be providing residents with six opportunities to have their sensitive documents professionally shredded. There is a five bag limit. No Businesses. Please contact us at 440-498-4400 if you have any questions.

**\*The time is from 9 a.m. until noon or until the truck is full.\***

## Television Recycling

Do not put televisions and other electronics in your curbside recycling container. Televisions are very difficult and expensive to recycle because of the heavy metals and glass. There is no ban on placing televisions in the regular trash but recycling options do exist. Best Buy stores will recycle televisions for a fee, currently the fee is \$29.99 per item. They will accept: tube TVs smaller than 32", Portable TVs, Flat-panel TVs: LCD, plasma, LED smaller than 50". Limit two TVs per household per day. They also accept many other electronic items free of charge. Visit their website at [www.bestbuy.com](http://www.bestbuy.com) for more information.



Cuyahoga County Solid Waste District has held seasonal collection events for televisions at their headquarters in Garfield Heights. There may be a fee for the service. Contact the Solid Waste District at 216-443-3749 or visit their website at [www.cuyahogarecycles.org](http://www.cuyahogarecycles.org).

## Recycle Batteries, Writing Tools and More at Staples®

### Single-Use Alkaline and Other Batteries

Staples stores accept several types of batteries including single-use alkaline (AA, AAA, C, etc.), Non-rechargeable lithium, Rechargeable Nickel cadmium (Ni-Cd), Lithium ion (Li-Ion), Small sealed lead acid (SSLA/Pb), Nickel metal hydride (Ni-MH), and Nickel zinc (Ni-ZN).



### Writing Tools

Do you have an excess of pens, mechanical pencils, markers, and crayons? Staples will accept these items in store.



### Coffee Brewers, Label Makers and More



Staples will also accept coffee brewers (less than 40 pounds), label makers, laminators, stylus pens, and calculators in store. You may recycle these items at their store located at 5950 Mayfield Road, Mayfield Heights or visit their website at [Staples.com](http://Staples.com) for more locations and information.

# February 2024

ALL ACTIVITIES ARE LOCATED AT ORANGE VILLAGE HALL  
4600 LANDER ROAD, UNLESS OTHERWISE NOTED  
BD - Building Department and SD - Service Department  
located at 4680 Lander Rd.

| Sunday  | Monday   | Tuesday   | Wednesday  | Thursday      | Friday   | Saturday      |   |  |   |   |   |   |   |   |   |   |   |    |    |    |    |    |    |    |    |    |    |    |    |    |    |    |    |    |    |    |    |    |    |  |  |  |  |  |  |  |  |  |  |   |   |   |   |   |   |   |   |  |  |  |  |  |   |   |   |   |   |   |   |   |   |    |    |    |    |    |    |    |    |    |    |    |    |    |    |    |    |    |    |    |    |    |    |  |  |  |  |  |  |  |  |  |  |              |              |
|---|--|---|--|---------------|--|---------------|---|--|---|---|---|---|---|---|---|---|---|----|----|----|----|----|----|----|----|----|----|----|----|----|----|----|----|----|----|----|----|----|----|--|--|--|--|--|--|--|--|--|--|---|---|---|---|---|---|---|---|--|--|--|--|--|---|---|---|---|---|---|---|---|---|----|----|----|----|----|----|----|----|----|----|----|----|----|----|----|----|----|----|----|----|----|----|--|--|--|--|--|--|--|--|--|--|--------------|--------------|
| <div>January 2024</div> <table><tr><td>S</td><td>M</td><td>T</td><td>W</td><td>T</td><td>F</td><td>S</td></tr><tr><td></td><td>1</td><td>2</td><td>3</td><td>4</td><td>5</td><td>6</td></tr><tr><td>7</td><td>8</td><td>9</td><td>10</td><td>11</td><td>12</td><td>13</td></tr><tr><td>14</td><td>15</td><td>16</td><td>17</td><td>18</td><td>19</td><td>20</td></tr><tr><td>21</td><td>22</td><td>23</td><td>24</td><td>25</td><td>26</td><td>27</td></tr><tr><td>28</td><td>29</td><td>30</td><td>31</td><td></td><td></td><td></td></tr><tr><td></td><td></td><td></td><td></td><td></td><td></td><td></td></tr></table> | S  | M   | T  | W             | T  | F             | S |  | 1 | 2 | 3 | 4 | 5 | 6 | 7 | 8 | 9 | 10 | 11 | 12 | 13 | 14 | 15 | 16 | 17 | 18 | 19 | 20 | 21 | 22 | 23 | 24 | 25 | 26 | 27 | 28 | 29 | 30 | 31 |  |  |  |  |  |  |  |  |  |  | <div>March 2024</div> <table><tr><td>S</td><td>M</td><td>T</td><td>W</td><td>T</td><td>F</td><td>S</td></tr><tr><td></td><td></td><td></td><td></td><td></td><td>1</td><td>2</td></tr><tr><td>3</td><td>4</td><td>5</td><td>6</td><td>7</td><td>8</td><td>9</td></tr><tr><td>10</td><td>11</td><td>12</td><td>13</td><td>14</td><td>15</td><td>16</td></tr><tr><td>17</td><td>18</td><td>19</td><td>20</td><td>21</td><td>22</td><td>23</td></tr><tr><td>24</td><td>25</td><td>26</td><td>27</td><td>28</td><td>29</td><td>30</td></tr><tr><td>31</td><td></td><td></td><td></td><td></td><td></td><td></td></tr></table> | S | M | T | W | T | F | S |  |  |  |  |  | 1 | 2 | 3 | 4 | 5 | 6 | 7 | 8 | 9 | 10 | 11 | 12 | 13 | 14 | 15 | 16 | 17 | 18 | 19 | 20 | 21 | 22 | 23 | 24 | 25 | 26 | 27 | 28 | 29 | 30 | 31 |  |  |  |  |  |  |  |  |  | <div>1</div> <div></div> <div>Computer, Flags &amp; Household Hazardous Waste Collection<br/>7 a.m. - 3 p.m. - SD</div> | <div>2</div> | <div>3</div> |
| S   | M  | T   | W  | T             | F  | S             |   |  |   |   |   |   |   |   |   |   |   |    |    |    |    |    |    |    |    |    |    |    |    |    |    |    |    |    |    |    |    |    |    |  |  |  |  |  |  |  |  |  |  |   |   |   |   |   |   |   |   |  |  |  |  |  |   |   |   |   |   |   |   |   |   |    |    |    |    |    |    |    |    |    |    |    |    |    |    |    |    |    |    |    |    |    |    |  |  |  |  |  |  |  |  |  |  |              |              |
|   | 1  | 2   | 3  | 4             | 5  | 6             |   |  |   |   |   |   |   |   |   |   |   |    |    |    |    |    |    |    |    |    |    |    |    |    |    |    |    |    |    |    |    |    |    |  |  |  |  |  |  |  |  |  |  |   |   |   |   |   |   |   |   |  |  |  |  |  |   |   |   |   |   |   |   |   |   |    |    |    |    |    |    |    |    |    |    |    |    |    |    |    |    |    |    |    |    |    |    |  |  |  |  |  |  |  |  |  |  |              |              |
| 7   | 8  | 9   | 10   | 11            | 12   | 13            |   |  |   |   |   |   |   |   |   |   |   |    |    |    |    |    |    |    |    |    |    |    |    |    |    |    |    |    |    |    |    |    |    |  |  |  |  |  |  |  |  |  |  |   |   |   |   |   |   |   |   |  |  |  |  |  |   |   |   |   |   |   |   |   |   |    |    |    |    |    |    |    |    |    |    |    |    |    |    |    |    |    |    |    |    |    |    |  |  |  |  |  |  |  |  |  |  |              |              |
| 14  | 15   | 16  | 17   | 18            | 19   | 20            |   |  |   |   |   |   |   |   |   |   |   |    |    |    |    |    |    |    |    |    |    |    |    |    |    |    |    |    |    |    |    |    |    |  |  |  |  |  |  |  |  |  |  |   |   |   |   |   |   |   |   |  |  |  |  |  |   |   |   |   |   |   |   |   |   |    |    |    |    |    |    |    |    |    |    |    |    |    |    |    |    |    |    |    |    |    |    |  |  |  |  |  |  |  |  |  |  |              |              |
| 21  | 22   | 23  | 24   | 25            | 26   | 27            |   |  |   |   |   |   |   |   |   |   |   |    |    |    |    |    |    |    |    |    |    |    |    |    |    |    |    |    |    |    |    |    |    |  |  |  |  |  |  |  |  |  |  |   |   |   |   |   |   |   |   |  |  |  |  |  |   |   |   |   |   |   |   |   |   |    |    |    |    |    |    |    |    |    |    |    |    |    |    |    |    |    |    |    |    |    |    |  |  |  |  |  |  |  |  |  |  |              |              |
| 28  | 29   | 30  | 31   |               |  |               |   |  |   |   |   |   |   |   |   |   |   |    |    |    |    |    |    |    |    |    |    |    |    |    |    |    |    |    |    |    |    |    |    |  |  |  |  |  |  |  |  |  |  |   |   |   |   |   |   |   |   |  |  |  |  |  |   |   |   |   |   |   |   |   |   |    |    |    |    |    |    |    |    |    |    |    |    |    |    |    |    |    |    |    |    |    |    |  |  |  |  |  |  |  |  |  |  |              |              |
|   |  |   |  |               |  |               |   |  |   |   |   |   |   |   |   |   |   |    |    |    |    |    |    |    |    |    |    |    |    |    |    |    |    |    |    |    |    |    |    |  |  |  |  |  |  |  |  |  |  |   |   |   |   |   |   |   |   |  |  |  |  |  |   |   |   |   |   |   |   |   |   |    |    |    |    |    |    |    |    |    |    |    |    |    |    |    |    |    |    |    |    |    |    |  |  |  |  |  |  |  |  |  |  |              |              |
| S   | M  | T   | W  | T             | F  | S             |   |  |   |   |   |   |   |   |   |   |   |    |    |    |    |    |    |    |    |    |    |    |    |    |    |    |    |    |    |    |    |    |    |  |  |  |  |  |  |  |  |  |  |   |   |   |   |   |   |   |   |  |  |  |  |  |   |   |   |   |   |   |   |   |   |    |    |    |    |    |    |    |    |    |    |    |    |    |    |    |    |    |    |    |    |    |    |  |  |  |  |  |  |  |  |  |  |              |              |
|   |  |   |  |               | 1  | 2             |   |  |   |   |   |   |   |   |   |   |   |    |    |    |    |    |    |    |    |    |    |    |    |    |    |    |    |    |    |    |    |    |    |  |  |  |  |  |  |  |  |  |  |   |   |   |   |   |   |   |   |  |  |  |  |  |   |   |   |   |   |   |   |   |   |    |    |    |    |    |    |    |    |    |    |    |    |    |    |    |    |    |    |    |    |    |    |  |  |  |  |  |  |  |  |  |  |              |              |
| 3   | 4  | 5   | 6  | 7             | 8  | 9             |   |  |   |   |   |   |   |   |   |   |   |    |    |    |    |    |    |    |    |    |    |    |    |    |    |    |    |    |    |    |    |    |    |  |  |  |  |  |  |  |  |  |  |   |   |   |   |   |   |   |   |  |  |  |  |  |   |   |   |   |   |   |   |   |   |    |    |    |    |    |    |    |    |    |    |    |    |    |    |    |    |    |    |    |    |    |    |  |  |  |  |  |  |  |  |  |  |              |              |
| 10  | 11   | 12  | 13   | 14            | 15   | 16            |   |  |   |   |   |   |   |   |   |   |   |    |    |    |    |    |    |    |    |    |    |    |    |    |    |    |    |    |    |    |    |    |    |  |  |  |  |  |  |  |  |  |  |   |   |   |   |   |   |   |   |  |  |  |  |  |   |   |   |   |   |   |   |   |   |    |    |    |    |    |    |    |    |    |    |    |    |    |    |    |    |    |    |    |    |    |    |  |  |  |  |  |  |  |  |  |  |              |              |
| 17  | 18   | 19  | 20   | 21            | 22   | 23            |   |  |   |   |   |   |   |   |   |   |   |    |    |    |    |    |    |    |    |    |    |    |    |    |    |    |    |    |    |    |    |    |    |  |  |  |  |  |  |  |  |  |  |   |   |   |   |   |   |   |   |  |  |  |  |  |   |   |   |   |   |   |   |   |   |    |    |    |    |    |    |    |    |    |    |    |    |    |    |    |    |    |    |    |    |    |    |  |  |  |  |  |  |  |  |  |  |              |              |
| 24  | 25   | 26  | 27   | 28            | 29   | 30            |   |  |   |   |   |   |   |   |   |   |   |    |    |    |    |    |    |    |    |    |    |    |    |    |    |    |    |    |    |    |    |    |    |  |  |  |  |  |  |  |  |  |  |   |   |   |   |   |   |   |   |  |  |  |  |  |   |   |   |   |   |   |   |   |   |    |    |    |    |    |    |    |    |    |    |    |    |    |    |    |    |    |    |    |    |    |    |  |  |  |  |  |  |  |  |  |  |              |              |
| 31  |  |   |  |               |  |               |   |  |   |   |   |   |   |   |   |   |   |    |    |    |    |    |    |    |    |    |    |    |    |    |    |    |    |    |    |    |    |    |    |  |  |  |  |  |  |  |  |  |  |   |   |   |   |   |   |   |   |  |  |  |  |  |   |   |   |   |   |   |   |   |   |    |    |    |    |    |    |    |    |    |    |    |    |    |    |    |    |    |    |    |    |    |    |  |  |  |  |  |  |  |  |  |  |              |              |
| <div>4</div>  | <div>5</div> <div>Trash/Recycling Pick up</div>  | <div>6</div> <div>Planning &amp; Zoning ABR Meeting - BD</div>  | <div>7</div> <div>Council Work Session/Special Meeting</div>   | <div>8</div>  | <div>9</div> <div></div> <div>Paper Shredding<br/>Orange Village SD<br/>4680 Lander Rd<br/>9am - Noon</div> | <div>10</div> |   |  |   |   |   |   |   |   |   |   |   |    |    |    |    |    |    |    |    |    |    |    |    |    |    |    |    |    |    |    |    |    |    |  |  |  |  |  |  |  |  |  |  |   |   |   |   |   |   |   |   |  |  |  |  |  |   |   |   |   |   |   |   |   |   |    |    |    |    |    |    |    |    |    |    |    |    |    |    |    |    |    |    |    |    |    |    |  |  |  |  |  |  |  |  |  |  |              |              |
| <div>11</div>   | <div>12</div> <div>Trash/Recycling Pick up</div>   | <div>13</div>   | <div>14</div> <div></div> <div>Ash Wednesday<br/>Finance Meeting<br/>Council Meeting</div> | <div>15</div> | <div>16</div> <div>Orange Schools Closed</div>   | <div>17</div> |   |  |   |   |   |   |   |   |   |   |   |    |    |    |    |    |    |    |    |    |    |    |    |    |    |    |    |    |    |    |    |    |    |  |  |  |  |  |  |  |  |  |  |   |   |   |   |   |   |   |   |  |  |  |  |  |   |   |   |   |   |   |   |   |   |    |    |    |    |    |    |    |    |    |    |    |    |    |    |    |    |    |    |    |    |    |    |  |  |  |  |  |  |  |  |  |  |              |              |
| <div>18</div>   | <div>19</div> <div></div> <div>Orange Schools Closed</div> <div>Trash/Recycling Pick up</div> | <div>20</div> <div>Planning &amp; Zoning ABR Meeting - BD</div> | <div>21</div>  | <div>22</div> | <div>23</div>  | <div>24</div> |   |  |   |   |   |   |   |   |   |   |   |    |    |    |    |    |    |    |    |    |    |    |    |    |    |    |    |    |    |    |    |    |    |  |  |  |  |  |  |  |  |  |  |   |   |   |   |   |   |   |   |  |  |  |  |  |   |   |   |   |   |   |   |   |   |    |    |    |    |    |    |    |    |    |    |    |    |    |    |    |    |    |    |    |    |    |    |  |  |  |  |  |  |  |  |  |  |              |              |
| <div>25</div>   | <div>26</div> <div>Trash/Recycling Pick up</div>   | <div>27</div>   | <div>28</div>  | <div>29</div> |  |               |   |  |   |   |   |   |   |   |   |   |   |    |    |    |    |    |    |    |    |    |    |    |    |    |    |    |    |    |    |    |    |    |    |  |  |  |  |  |  |  |  |  |  |   |   |   |   |   |   |   |   |  |  |  |  |  |   |   |   |   |   |   |   |   |   |    |    |    |    |    |    |    |    |    |    |    |    |    |    |    |    |    |    |    |    |    |    |  |  |  |  |  |  |  |  |  |  |              |              |

## Order your Leaf Humus Beginning March 4

### How it works:

- ◆ Leaf Humus is delivered to your home free of charge. Requests are honored in the order of receipt, while supplies last.
- ◆ We will deliver one load (approximately 7 yards) to each person who places a request. If you request more than one load, you may receive the additional loads once everyone has received their first load.
- ◆ When you place an order, we will ask you to describe where to place the delivery as if you are standing at the street looking down your drive toward your home.



You can place your order on our website at [www.orangevillage.com](http://www.orangevillage.com) or by contacting Orange Village at 440-498-4400.

## Carbon Monoxide Detector...Do You Have One?

The Orange Village Fire Department would like to remind everyone about the importance of having at least one **carbon monoxide detector** in your home. A carbon monoxide (CO) detector is essential if you have a working fireplace, gas kitchen appliances, clothes dryer, furnace or a hot water tank fueled by natural gas!

Carbon monoxide is an odorless, colorless gas that is a by-product of incomplete burning in gas appliances. Exposure to high levels of CO can be fatal. Continuous exposure to lower levels over time can cause illness too. We recommend installing a CO detector on each level of your home. If you only have one detector, install it near the bedrooms in your home.

CO detectors do have a working lifespan of 7-10 years. Make sure your CO detector is less than 10 years old and has fresh batteries before those furnaces turn on! CO detectors save lives!!

### Fall Fire and Life Safety Tips:

- Have your furnace and fireplace inspected *annually*
- Keep storage and debris from collecting around furnaces and hot water tanks
- Ensure your smoke and CO detector batteries are fresh
- **Do not warm up a vehicle inside your garage, even with the garage door open!**
- Burning yard waste and leaves is prohibited by law



The Fire Department is happy to assist residents who may be unable to install a detector. Please give us a call at 440-498-4402 for help or any other safety related questions you may have!

## Spring Forward - Daylight Savings Time Begins



A friendly reminder to turn your clocks forward one hour. Daylight savings time officially begins at 2:00 a.m., Sunday March 10. This is also a great time to change the batteries in your smoke detectors.



Visit Cuyahoga County Solid Waste District's website at <http://cuyahogarecycles.org/> to answer any of your recycling questions.

# March 2024

ALL ACTIVITIES ARE LOCATED AT ORANGE VILLAGE HALL  
4600 LANDER ROAD, UNLESS OTHERWISE NOTED  
BD - Building Department and SD - Service Department  
located at 4680 Lander Rd.

| Sunday  | Monday   | Tuesday   | Wednesday  | Thursday  | Friday   | Saturday  |   |  |  |  |  |   |   |   |   |   |   |   |   |   |    |    |    |    |    |    |    |    |    |    |    |    |    |    |    |    |    |    |    |    |  |  |  |   |   |   |   |   |   |   |  |   |   |   |   |   |   |   |   |   |    |    |    |    |    |    |    |    |    |    |    |    |    |    |    |    |    |    |    |    |    |  |  |  |  |  |  |  |   |          |
|---|--|---|--|-----------|--|-----------|---|--|--|--|--|---|---|---|---|---|---|---|---|---|----|----|----|----|----|----|----|----|----|----|----|----|----|----|----|----|----|----|----|----|--|--|--|---|---|---|---|---|---|---|--|---|---|---|---|---|---|---|---|---|----|----|----|----|----|----|----|----|----|----|----|----|----|----|----|----|----|----|----|----|----|--|--|--|--|--|--|--|---|----------|
| <p>February 2024</p> <table> <tr><td>S</td><td>M</td><td>T</td><td>W</td><td>T</td><td>F</td><td>S</td></tr> <tr><td></td><td></td><td></td><td></td><td>1</td><td>2</td><td>3</td></tr> <tr><td>4</td><td>5</td><td>6</td><td>7</td><td>8</td><td>9</td><td>10</td></tr> <tr><td>11</td><td>12</td><td>13</td><td>14</td><td>15</td><td>16</td><td>17</td></tr> <tr><td>18</td><td>19</td><td>20</td><td>21</td><td>22</td><td>23</td><td>24</td></tr> <tr><td>25</td><td>26</td><td>27</td><td>28</td><td>29</td><td></td><td></td></tr> </table> | S  | M   | T  | W         | T  | F         | S |  |  |  |  | 1 | 2 | 3 | 4 | 5 | 6 | 7 | 8 | 9 | 10 | 11 | 12 | 13 | 14 | 15 | 16 | 17 | 18 | 19 | 20 | 21 | 22 | 23 | 24 | 25 | 26 | 27 | 28 | 29 |  |  | <p>April 2024</p> <table> <tr><td>S</td><td>M</td><td>T</td><td>W</td><td>T</td><td>F</td><td>S</td></tr> <tr><td></td><td>1</td><td>2</td><td>3</td><td>4</td><td>5</td><td>6</td></tr> <tr><td>7</td><td>8</td><td>9</td><td>10</td><td>11</td><td>12</td><td>13</td></tr> <tr><td>14</td><td>15</td><td>16</td><td>17</td><td>18</td><td>19</td><td>20</td></tr> <tr><td>21</td><td>22</td><td>23</td><td>24</td><td>25</td><td>26</td><td>27</td></tr> <tr><td>28</td><td>29</td><td>30</td><td></td><td></td><td></td><td></td></tr> </table> | S | M | T | W | T | F | S |  | 1 | 2 | 3 | 4 | 5 | 6 | 7 | 8 | 9 | 10 | 11 | 12 | 13 | 14 | 15 | 16 | 17 | 18 | 19 | 20 | 21 | 22 | 23 | 24 | 25 | 26 | 27 | 28 | 29 | 30 |  |  |  |  |  |  |  |  <p>1</p> <p>Computer, Flags &amp; Household Hazardous Waste Collection<br/>7 a.m. - 3 p.m. - SD</p> | <p>2</p> |
| S   | M  | T   | W  | T         | F  | S         |   |  |  |  |  |   |   |   |   |   |   |   |   |   |    |    |    |    |    |    |    |    |    |    |    |    |    |    |    |    |    |    |    |    |  |  |  |   |   |   |   |   |   |   |  |   |   |   |   |   |   |   |   |   |    |    |    |    |    |    |    |    |    |    |    |    |    |    |    |    |    |    |    |    |    |  |  |  |  |  |  |  |   |          |
|   |  |   |  | 1         | 2  | 3         |   |  |  |  |  |   |   |   |   |   |   |   |   |   |    |    |    |    |    |    |    |    |    |    |    |    |    |    |    |    |    |    |    |    |  |  |  |   |   |   |   |   |   |   |  |   |   |   |   |   |   |   |   |   |    |    |    |    |    |    |    |    |    |    |    |    |    |    |    |    |    |    |    |    |    |  |  |  |  |  |  |  |   |          |
| 4   | 5  | 6   | 7  | 8         | 9  | 10        |   |  |  |  |  |   |   |   |   |   |   |   |   |   |    |    |    |    |    |    |    |    |    |    |    |    |    |    |    |    |    |    |    |    |  |  |  |   |   |   |   |   |   |   |  |   |   |   |   |   |   |   |   |   |    |    |    |    |    |    |    |    |    |    |    |    |    |    |    |    |    |    |    |    |    |  |  |  |  |  |  |  |   |          |
| 11  | 12   | 13  | 14   | 15        | 16   | 17        |   |  |  |  |  |   |   |   |   |   |   |   |   |   |    |    |    |    |    |    |    |    |    |    |    |    |    |    |    |    |    |    |    |    |  |  |  |   |   |   |   |   |   |   |  |   |   |   |   |   |   |   |   |   |    |    |    |    |    |    |    |    |    |    |    |    |    |    |    |    |    |    |    |    |    |  |  |  |  |  |  |  |   |          |
| 18  | 19   | 20  | 21   | 22        | 23   | 24        |   |  |  |  |  |   |   |   |   |   |   |   |   |   |    |    |    |    |    |    |    |    |    |    |    |    |    |    |    |    |    |    |    |    |  |  |  |   |   |   |   |   |   |   |  |   |   |   |   |   |   |   |   |   |    |    |    |    |    |    |    |    |    |    |    |    |    |    |    |    |    |    |    |    |    |  |  |  |  |  |  |  |   |          |
| 25  | 26   | 27  | 28   | 29        |  |           |   |  |  |  |  |   |   |   |   |   |   |   |   |   |    |    |    |    |    |    |    |    |    |    |    |    |    |    |    |    |    |    |    |    |  |  |  |   |   |   |   |   |   |   |  |   |   |   |   |   |   |   |   |   |    |    |    |    |    |    |    |    |    |    |    |    |    |    |    |    |    |    |    |    |    |  |  |  |  |  |  |  |   |          |
| S   | M  | T   | W  | T         | F  | S         |   |  |  |  |  |   |   |   |   |   |   |   |   |   |    |    |    |    |    |    |    |    |    |    |    |    |    |    |    |    |    |    |    |    |  |  |  |   |   |   |   |   |   |   |  |   |   |   |   |   |   |   |   |   |    |    |    |    |    |    |    |    |    |    |    |    |    |    |    |    |    |    |    |    |    |  |  |  |  |  |  |  |   |          |
|   | 1  | 2   | 3  | 4         | 5  | 6         |   |  |  |  |  |   |   |   |   |   |   |   |   |   |    |    |    |    |    |    |    |    |    |    |    |    |    |    |    |    |    |    |    |    |  |  |  |   |   |   |   |   |   |   |  |   |   |   |   |   |   |   |   |   |    |    |    |    |    |    |    |    |    |    |    |    |    |    |    |    |    |    |    |    |    |  |  |  |  |  |  |  |   |          |
| 7   | 8  | 9   | 10   | 11        | 12   | 13        |   |  |  |  |  |   |   |   |   |   |   |   |   |   |    |    |    |    |    |    |    |    |    |    |    |    |    |    |    |    |    |    |    |    |  |  |  |   |   |   |   |   |   |   |  |   |   |   |   |   |   |   |   |   |    |    |    |    |    |    |    |    |    |    |    |    |    |    |    |    |    |    |    |    |    |  |  |  |  |  |  |  |   |          |
| 14  | 15   | 16  | 17   | 18        | 19   | 20        |   |  |  |  |  |   |   |   |   |   |   |   |   |   |    |    |    |    |    |    |    |    |    |    |    |    |    |    |    |    |    |    |    |    |  |  |  |   |   |   |   |   |   |   |  |   |   |   |   |   |   |   |   |   |    |    |    |    |    |    |    |    |    |    |    |    |    |    |    |    |    |    |    |    |    |  |  |  |  |  |  |  |   |          |
| 21  | 22   | 23  | 24   | 25        | 26   | 27        |   |  |  |  |  |   |   |   |   |   |   |   |   |   |    |    |    |    |    |    |    |    |    |    |    |    |    |    |    |    |    |    |    |    |  |  |  |   |   |   |   |   |   |   |  |   |   |   |   |   |   |   |   |   |    |    |    |    |    |    |    |    |    |    |    |    |    |    |    |    |    |    |    |    |    |  |  |  |  |  |  |  |   |          |
| 28  | 29   | 30  |  |           |  |           |   |  |  |  |  |   |   |   |   |   |   |   |   |   |    |    |    |    |    |    |    |    |    |    |    |    |    |    |    |    |    |    |    |    |  |  |  |   |   |   |   |   |   |   |  |   |   |   |   |   |   |   |   |   |    |    |    |    |    |    |    |    |    |    |    |    |    |    |    |    |    |    |    |    |    |  |  |  |  |  |  |  |   |          |
| <p>3</p>  |  <p>4</p> <p>Accepting leaf humus orders</p> <p>Trash/Recycling Pick up</p> | <p>5</p> <p>Planning &amp; Zoning ABR Meeting - BD</p>  | <p>6</p> <p>Council Work Session/Special Meeting</p> | <p>7</p>  | <p>8</p>   | <p>9</p>  |   |  |  |  |  |   |   |   |   |   |   |   |   |   |    |    |    |    |    |    |    |    |    |    |    |    |    |    |    |    |    |    |    |    |  |  |  |   |   |   |   |   |   |   |  |   |   |   |   |   |   |   |   |   |    |    |    |    |    |    |    |    |    |    |    |    |    |    |    |    |    |    |    |    |    |  |  |  |  |  |  |  |   |          |
|  <p>10</p> <p>Daylight Savings Time Begins</p>  |  <p>11</p> <p>Ramadan Begins</p> <p>Trash/Recycling Pick up</p>             | <p>12</p>   | <p>13</p> <p>Finance Meeting<br/>Council Meeting</p> | <p>14</p> | <p>15</p>  | <p>16</p> |   |  |  |  |  |   |   |   |   |   |   |   |   |   |    |    |    |    |    |    |    |    |    |    |    |    |    |    |    |    |    |    |    |    |  |  |  |   |   |   |   |   |   |   |  |   |   |   |   |   |   |   |   |   |    |    |    |    |    |    |    |    |    |    |    |    |    |    |    |    |    |    |    |    |    |  |  |  |  |  |  |  |   |          |
|  <p>17</p>   | <p>18</p> <p>Trash/Recycling Pick up</p>   | <p>19</p> <p>Planning &amp; Zoning ABR Meeting - BD</p> | <p>20</p> <p>First Day of<br/>SPRING</p>             | <p>21</p> | <p>22</p>  | <p>23</p> |   |  |  |  |  |   |   |   |   |   |   |   |   |   |    |    |    |    |    |    |    |    |    |    |    |    |    |    |    |    |    |    |    |    |  |  |  |   |   |   |   |   |   |   |  |   |   |   |   |   |   |   |   |   |    |    |    |    |    |    |    |    |    |    |    |    |    |    |    |    |    |    |    |    |    |  |  |  |  |  |  |  |   |          |
|  <p>24</p>   | <p>25</p>  | <p>26</p>   | <p>27</p>  | <p>28</p> | <p>29</p>  | <p>30</p> |   |  |  |  |  |   |   |   |   |   |   |   |   |   |    |    |    |    |    |    |    |    |    |    |    |    |    |    |    |    |    |    |    |    |  |  |  |   |   |   |   |   |   |   |  |   |   |   |   |   |   |   |   |   |    |    |    |    |    |    |    |    |    |    |    |    |    |    |    |    |    |    |    |    |    |  |  |  |  |  |  |  |   |          |
|  <p>31</p> <p>Easter Sunday</p>   | <p>Trash/Recycling Pick up</p>   | <p>Spring Break - Orange Schools Closed</p>             |  |           |  |           |   |  |  |  |  |   |   |   |   |   |   |   |   |   |    |    |    |    |    |    |    |    |    |    |    |    |    |    |    |    |    |    |    |    |  |  |  |   |   |   |   |   |   |   |  |   |   |   |   |   |   |   |   |   |    |    |    |    |    |    |    |    |    |    |    |    |    |    |    |    |    |    |    |    |    |  |  |  |  |  |  |  |   |          |
|   |  |   |  |           |  <p>Good Friday</p> |           |   |  |  |  |  |   |   |   |   |   |   |   |   |   |    |    |    |    |    |    |    |    |    |    |    |    |    |    |    |    |    |    |    |    |  |  |  |   |   |   |   |   |   |   |  |   |   |   |   |   |   |   |   |   |    |    |    |    |    |    |    |    |    |    |    |    |    |    |    |    |    |    |    |    |    |  |  |  |  |  |  |  |   |          |

## Branch and Brush Collection

The Orange Village Service Department will be collecting branches and brush on April 22, June 10, July 22 and September 16. This service is to aid the residents in the management of tree prunings and limbs that have fallen from their trees.

### **Brush Pickup Requirements**

In an effort to provide residents with the highest level of service and to minimize the risk of injury to employees or damage to equipment, the following regulations will be strictly enforced:

- No foreign material (i.e. rope, metal, wood posts, construction wood, split rail fence, railroad ties or any material that could contain nails or metal, stumps and root balls).
- DO NOT mix leaves, grass clippings or yard material with branches.
- DO NOT place out any material with thorns.
- DO NOT make large piles.
- Limbs shall be placed with cut ends towards the road, no more than 2 feet high and 3 feet wide. Piles must be able to be picked up by one person.
- Long lengths are acceptable, if they can be handled by one person.
- Limbs should be no larger than 6 inches in diameter.
- Small material shorter than 2 feet in length shall be bundled or placed in a container.
- Branches should not be placed roadside any more than a few days before the scheduled chipping date. Branches must be out by 7:00 a.m. on the scheduled date. The Service Department makes one complete pass through the Village beginning on the scheduled day and ending once a complete pass of the Village has been made.
- Branches placed out too early or too late must be removed by the resident.

Non-compliance of these rules may result in non-removal of your material. If you are removing a tree or having one removed, please dispose of the material in another way.

**This service is not intended to chip complete trees.**

**Wood Chips...** *Orange Village delivers the wood chips that are collected during branch chipping, free of charge to residents. An approximate load size is 10 yards. Requests are honored in the order they are received, while supplies last. Place your order online at [www.orangevillage.com](http://www.orangevillage.com) or call Village Hall at 440-498-4400.*

## Computer Recycling

*Weekdays during April and August and the first Friday of every month*

Orange Village Service Department, 4680 Lander Road 7 a.m. - 3 p.m. Monday through Friday

### ***What kind of computer equipment can be recycled?***

Computers/laptops, tablets/e-readers, monitors, keyboards, mice, cords, printers, cell phones, telecom and networking equipment, servers, video games, stereo equipment, electronic equipment batteries, ink and toner cartridges, DVD/CD/Media players and cable boxes.

### ***What will happen to the computers that are collected?***

Orange Village partners with Cuyahoga County Solid Waste District and RET3 Job Corp. Computer and electronic equipment that can be reused are refurbished and donated to schools and other non-profit organizations.

### ***What will happen to the data on my computer?***

All computer hard drives received by RET3 are erased of all data using U.S. Department of Defense certified sanitization methods. This secure system eradicates all the information stored on your computer and protects your confidentiality. If your donation does not meet school specifications, RET3 Job Corp. will recycle the equipment in a process that is fully compliant with EPA standards and offers a 100% no-landfill guarantee.



## Miscellaneous Items for CURBSIDE TRASH Pickup

The following items may be placed at the curb on pickup day.

If the items are large, as a courtesy, please contact Kimble Refuse directly at 1-800-201-0005 to notify them of an "oversized" pick-up.

**Latex Paint** is a non-hazardous material and can be disposed of with your regular trash, **once it has been dried**. To dry or harden latex paint add sand, sawdust, plaster of paris, vermiculite, cat litter or a paint hardener (available at hardware stores). For small amount of latex paint (1 inch or less), remove the lid and allow paint to air dry. Place cans of latex paint curbside without the lids.



**Syringes & Lancets** must be disposed of safely. Place them in a "sharps container", such as an empty 2 liter pop bottle or empty detergent bottle (labeled "SHARPS"). Secure the cap, then dispose with your regular **trash**.



**Cooking Oils** should not be disposed of down your drains. The oil should be collected in clear plastic containers that have been **clearly marked cooking oil** and disposed of in your household hazardous waste collection. Small amounts may be put in your trash after they are hardened with kitty litter to prevent fires or spills.



**Household Fixtures**, such as bathtubs, utility tubs, toilets, kitchen sinks, etc.



**Lumber & Wood Building Materials** must be cut into 4 foot lengths and bundled with non-metallic ties. Sheet rock (dry wall), must be cut into 4 foot or less pieces. For safety, please remove all nails from any building materials. This is a service for our residents, it is not intended for use by contractors.



**Household Appliances**, such as washers, dryers, etc. will be picked up on your regular collection day. Doors must be removed from refrigerators/freezers. The law requires the removal of Freon by a properly trained individual.



**Furniture and Mattresses** (mattresses must be covered in plastic and taped closed) should be placed on the curb on your regular collection day. Keep in mind you may also donate your gently-used furniture for reuse. Visit the Cuyahoga County Solid Waste District's website at [www.cuyahogarecycles.org](http://www.cuyahogarecycles.org) for more information.



**Carpet & Padding** will be taken on your regular collection day if it is neatly rolled or folded and tied in pieces no longer than 4 feet and weighing no more than 50 pounds and placed at the curb.



### ENERGY STAR®

The U.S. Environmental Protection Agency (EPA) launched the ENERGY STAR program in 1992. Since then, ENERGY STAR and its partners have helped American families and businesses save 5 trillion kilowatt-hours of electricity, avoid more than \$500 billion in energy costs and achieve 4 billion metric tons of greenhouse gas reductions.



ENERGY STAR is a voluntary labeling program: EPA sets energy efficiency specifications and those that meet them can choose to display the ENERGY STAR logo. Before you shop for new appliances, water heaters, heating/cooling items Visit the ENERGY STAR website at [www.energystar.gov](http://www.energystar.gov) for possible rebates.

# May 2024

ALL ACTIVITIES ARE LOCATED AT ORANGE VILLAGE HALL  
4600 LANDER ROAD, UNLESS OTHERWISE NOTED  
BD - Building Department and SD - Service Department  
located at 4680 Lander Rd.

| Sunday  | Monday  | Tuesday  | Wednesday   | Thursday      | Friday        | Saturday      |   |  |   |   |   |   |   |   |   |   |   |    |    |    |    |    |    |    |    |    |    |    |    |    |    |    |    |    |    |    |    |    |  |  |  |  |  |  |  |  |  |  |  |  |   |   |   |   |   |   |   |  |  |  |  |  |  |   |   |   |   |   |   |   |   |   |    |    |    |    |    |    |    |    |    |    |    |    |    |    |    |    |    |    |    |    |    |  |  |  |  |  |  |  |  |              |  |              |
|---|---|--|---|---------------|---------------|---------------|---|--|---|---|---|---|---|---|---|---|---|----|----|----|----|----|----|----|----|----|----|----|----|----|----|----|----|----|----|----|----|----|--|--|--|--|--|--|--|--|--|--|--|--|---|---|---|---|---|---|---|--|--|--|--|--|--|---|---|---|---|---|---|---|---|---|----|----|----|----|----|----|----|----|----|----|----|----|----|----|----|----|----|----|----|----|----|--|--|--|--|--|--|--|--|--------------|--|--------------|
| <div>April 2024</div> <table> <tr><td>S</td><td>M</td><td>T</td><td>W</td><td>T</td><td>F</td><td>S</td></tr> <tr><td></td><td>1</td><td>2</td><td>3</td><td>4</td><td>5</td><td>6</td></tr> <tr><td>7</td><td>8</td><td>9</td><td>10</td><td>11</td><td>12</td><td>13</td></tr> <tr><td>14</td><td>15</td><td>16</td><td>17</td><td>18</td><td>19</td><td>20</td></tr> <tr><td>21</td><td>22</td><td>23</td><td>24</td><td>25</td><td>26</td><td>27</td></tr> <tr><td>28</td><td>29</td><td>30</td><td></td><td></td><td></td><td></td></tr> <tr><td></td><td></td><td></td><td></td><td></td><td></td><td></td></tr> </table> | S   | M  | T   | W             | T             | F             | S |  | 1 | 2 | 3 | 4 | 5 | 6 | 7 | 8 | 9 | 10 | 11 | 12 | 13 | 14 | 15 | 16 | 17 | 18 | 19 | 20 | 21 | 22 | 23 | 24 | 25 | 26 | 27 | 28 | 29 | 30 |  |  |  |  |  |  |  |  |  |  |  | <div>June 2024</div> <table> <tr><td>S</td><td>M</td><td>T</td><td>W</td><td>T</td><td>F</td><td>S</td></tr> <tr><td></td><td></td><td></td><td></td><td></td><td></td><td>1</td></tr> <tr><td>2</td><td>3</td><td>4</td><td>5</td><td>6</td><td>7</td><td>8</td></tr> <tr><td>9</td><td>10</td><td>11</td><td>12</td><td>13</td><td>14</td><td>15</td></tr> <tr><td>16</td><td>17</td><td>18</td><td>19</td><td>20</td><td>21</td><td>22</td></tr> <tr><td>23</td><td>24</td><td>25</td><td>26</td><td>27</td><td>28</td><td>29</td></tr> <tr><td>30</td><td></td><td></td><td></td><td></td><td></td><td></td></tr> </table> | S | M | T | W | T | F | S |  |  |  |  |  |  | 1 | 2 | 3 | 4 | 5 | 6 | 7 | 8 | 9 | 10 | 11 | 12 | 13 | 14 | 15 | 16 | 17 | 18 | 19 | 20 | 21 | 22 | 23 | 24 | 25 | 26 | 27 | 28 | 29 | 30 |  |  |  |  |  |  |  | <div>1</div> <div>Council Work Session/Special Meeting</div> | <div>2</div> | <div>  <div>3</div> <div>Computer, Flags &amp; Household Hazardous Waste Collection<br/>7 a.m. - 3 p.m. - SD</div> </div> | <div>4</div> |
| S   | M   | T  | W   | T             | F             | S             |   |  |   |   |   |   |   |   |   |   |   |    |    |    |    |    |    |    |    |    |    |    |    |    |    |    |    |    |    |    |    |    |  |  |  |  |  |  |  |  |  |  |  |  |   |   |   |   |   |   |   |  |  |  |  |  |  |   |   |   |   |   |   |   |   |   |    |    |    |    |    |    |    |    |    |    |    |    |    |    |    |    |    |    |    |    |    |  |  |  |  |  |  |  |  |              |  |              |
|   | 1   | 2  | 3   | 4             | 5             | 6             |   |  |   |   |   |   |   |   |   |   |   |    |    |    |    |    |    |    |    |    |    |    |    |    |    |    |    |    |    |    |    |    |  |  |  |  |  |  |  |  |  |  |  |  |   |   |   |   |   |   |   |  |  |  |  |  |  |   |   |   |   |   |   |   |   |   |    |    |    |    |    |    |    |    |    |    |    |    |    |    |    |    |    |    |    |    |    |  |  |  |  |  |  |  |  |              |  |              |
| 7   | 8   | 9  | 10  | 11            | 12            | 13            |   |  |   |   |   |   |   |   |   |   |   |    |    |    |    |    |    |    |    |    |    |    |    |    |    |    |    |    |    |    |    |    |  |  |  |  |  |  |  |  |  |  |  |  |   |   |   |   |   |   |   |  |  |  |  |  |  |   |   |   |   |   |   |   |   |   |    |    |    |    |    |    |    |    |    |    |    |    |    |    |    |    |    |    |    |    |    |  |  |  |  |  |  |  |  |              |  |              |
| 14  | 15  | 16   | 17  | 18            | 19            | 20            |   |  |   |   |   |   |   |   |   |   |   |    |    |    |    |    |    |    |    |    |    |    |    |    |    |    |    |    |    |    |    |    |  |  |  |  |  |  |  |  |  |  |  |  |   |   |   |   |   |   |   |  |  |  |  |  |  |   |   |   |   |   |   |   |   |   |    |    |    |    |    |    |    |    |    |    |    |    |    |    |    |    |    |    |    |    |    |  |  |  |  |  |  |  |  |              |  |              |
| 21  | 22  | 23   | 24  | 25            | 26            | 27            |   |  |   |   |   |   |   |   |   |   |   |    |    |    |    |    |    |    |    |    |    |    |    |    |    |    |    |    |    |    |    |    |  |  |  |  |  |  |  |  |  |  |  |  |   |   |   |   |   |   |   |  |  |  |  |  |  |   |   |   |   |   |   |   |   |   |    |    |    |    |    |    |    |    |    |    |    |    |    |    |    |    |    |    |    |    |    |  |  |  |  |  |  |  |  |              |  |              |
| 28  | 29  | 30   |   |               |               |               |   |  |   |   |   |   |   |   |   |   |   |    |    |    |    |    |    |    |    |    |    |    |    |    |    |    |    |    |    |    |    |    |  |  |  |  |  |  |  |  |  |  |  |  |   |   |   |   |   |   |   |  |  |  |  |  |  |   |   |   |   |   |   |   |   |   |    |    |    |    |    |    |    |    |    |    |    |    |    |    |    |    |    |    |    |    |    |  |  |  |  |  |  |  |  |              |  |              |
|   |   |  |   |               |               |               |   |  |   |   |   |   |   |   |   |   |   |    |    |    |    |    |    |    |    |    |    |    |    |    |    |    |    |    |    |    |    |    |  |  |  |  |  |  |  |  |  |  |  |  |   |   |   |   |   |   |   |  |  |  |  |  |  |   |   |   |   |   |   |   |   |   |    |    |    |    |    |    |    |    |    |    |    |    |    |    |    |    |    |    |    |    |    |  |  |  |  |  |  |  |  |              |  |              |
| S   | M   | T  | W   | T             | F             | S             |   |  |   |   |   |   |   |   |   |   |   |    |    |    |    |    |    |    |    |    |    |    |    |    |    |    |    |    |    |    |    |    |  |  |  |  |  |  |  |  |  |  |  |  |   |   |   |   |   |   |   |  |  |  |  |  |  |   |   |   |   |   |   |   |   |   |    |    |    |    |    |    |    |    |    |    |    |    |    |    |    |    |    |    |    |    |    |  |  |  |  |  |  |  |  |              |  |              |
|   |   |  |   |               |               | 1             |   |  |   |   |   |   |   |   |   |   |   |    |    |    |    |    |    |    |    |    |    |    |    |    |    |    |    |    |    |    |    |    |  |  |  |  |  |  |  |  |  |  |  |  |   |   |   |   |   |   |   |  |  |  |  |  |  |   |   |   |   |   |   |   |   |   |    |    |    |    |    |    |    |    |    |    |    |    |    |    |    |    |    |    |    |    |    |  |  |  |  |  |  |  |  |              |  |              |
| 2   | 3   | 4  | 5   | 6             | 7             | 8             |   |  |   |   |   |   |   |   |   |   |   |    |    |    |    |    |    |    |    |    |    |    |    |    |    |    |    |    |    |    |    |    |  |  |  |  |  |  |  |  |  |  |  |  |   |   |   |   |   |   |   |  |  |  |  |  |  |   |   |   |   |   |   |   |   |   |    |    |    |    |    |    |    |    |    |    |    |    |    |    |    |    |    |    |    |    |    |  |  |  |  |  |  |  |  |              |  |              |
| 9   | 10  | 11   | 12  | 13            | 14            | 15            |   |  |   |   |   |   |   |   |   |   |   |    |    |    |    |    |    |    |    |    |    |    |    |    |    |    |    |    |    |    |    |    |  |  |  |  |  |  |  |  |  |  |  |  |   |   |   |   |   |   |   |  |  |  |  |  |  |   |   |   |   |   |   |   |   |   |    |    |    |    |    |    |    |    |    |    |    |    |    |    |    |    |    |    |    |    |    |  |  |  |  |  |  |  |  |              |  |              |
| 16  | 17  | 18   | 19  | 20            | 21            | 22            |   |  |   |   |   |   |   |   |   |   |   |    |    |    |    |    |    |    |    |    |    |    |    |    |    |    |    |    |    |    |    |    |  |  |  |  |  |  |  |  |  |  |  |  |   |   |   |   |   |   |   |  |  |  |  |  |  |   |   |   |   |   |   |   |   |   |    |    |    |    |    |    |    |    |    |    |    |    |    |    |    |    |    |    |    |    |    |  |  |  |  |  |  |  |  |              |  |              |
| 23  | 24  | 25   | 26  | 27            | 28            | 29            |   |  |   |   |   |   |   |   |   |   |   |    |    |    |    |    |    |    |    |    |    |    |    |    |    |    |    |    |    |    |    |    |  |  |  |  |  |  |  |  |  |  |  |  |   |   |   |   |   |   |   |  |  |  |  |  |  |   |   |   |   |   |   |   |   |   |    |    |    |    |    |    |    |    |    |    |    |    |    |    |    |    |    |    |    |    |    |  |  |  |  |  |  |  |  |              |  |              |
| 30  |   |  |   |               |               |               |   |  |   |   |   |   |   |   |   |   |   |    |    |    |    |    |    |    |    |    |    |    |    |    |    |    |    |    |    |    |    |    |  |  |  |  |  |  |  |  |  |  |  |  |   |   |   |   |   |   |   |  |  |  |  |  |  |   |   |   |   |   |   |   |   |   |    |    |    |    |    |    |    |    |    |    |    |    |    |    |    |    |    |    |    |    |    |  |  |  |  |  |  |  |  |              |  |              |
| <div>5</div> <div>CINCO DE MAYO</div>   | <div>6</div> <div>Trash/Recycling Pick up</div>   | <div>7</div> <div>Planning &amp; Zoning ABR Meeting - BD</div>   | <div>8</div> <div>Finance Meeting<br/>Council Meeting</div> | <div>9</div>  | <div>10</div> | <div>11</div> |   |  |   |   |   |   |   |   |   |   |   |    |    |    |    |    |    |    |    |    |    |    |    |    |    |    |    |    |    |    |    |    |  |  |  |  |  |  |  |  |  |  |  |  |   |   |   |   |   |   |   |  |  |  |  |  |  |   |   |   |   |   |   |   |   |   |    |    |    |    |    |    |    |    |    |    |    |    |    |    |    |    |    |    |    |    |    |  |  |  |  |  |  |  |  |              |  |              |
| <div>12</div> <div>HAPPY Mother's Day</div>   | <div>13</div> <div>Trash/Recycling Pick up</div>  | <div>14</div>  | <div>15</div>   | <div>16</div> | <div>17</div> | <div>18</div> |   |  |   |   |   |   |   |   |   |   |   |    |    |    |    |    |    |    |    |    |    |    |    |    |    |    |    |    |    |    |    |    |  |  |  |  |  |  |  |  |  |  |  |  |   |   |   |   |   |   |   |  |  |  |  |  |  |   |   |   |   |   |   |   |   |   |    |    |    |    |    |    |    |    |    |    |    |    |    |    |    |    |    |    |    |    |    |  |  |  |  |  |  |  |  |              |  |              |
| <div>19</div>   | <div>20</div> <div>Trash/Recycling Pick up</div>  | <div>21</div> <div>Planning &amp; Zoning ABR Meeting - BD.</div> | <div>22</div>   | <div>23</div> | <div>24</div> | <div>25</div> |   |  |   |   |   |   |   |   |   |   |   |    |    |    |    |    |    |    |    |    |    |    |    |    |    |    |    |    |    |    |    |    |  |  |  |  |  |  |  |  |  |  |  |  |   |   |   |   |   |   |   |  |  |  |  |  |  |   |   |   |   |   |   |   |   |   |    |    |    |    |    |    |    |    |    |    |    |    |    |    |    |    |    |    |    |    |    |  |  |  |  |  |  |  |  |              |  |              |
| <div>26</div>   | <div> <div>MEMORIAL DAY</div> <div>REMEMBER AND HONOR</div> <div>Village Hall Closed</div> <div>NO Trash/Recycling Pick up</div> </div> <div>27</div> | <div>28</div> <div>Trash/Recycling Pick up</div>                 | <div>29</div>   | <div>30</div> | <div>31</div> |               |   |  |   |   |   |   |   |   |   |   |   |    |    |    |    |    |    |    |    |    |    |    |    |    |    |    |    |    |    |    |    |    |  |  |  |  |  |  |  |  |  |  |  |  |   |   |   |   |   |   |   |  |  |  |  |  |  |   |   |   |   |   |   |   |   |   |    |    |    |    |    |    |    |    |    |    |    |    |    |    |    |    |    |    |    |    |    |  |  |  |  |  |  |  |  |              |  |              |

# COMMUNITY-WIDE GARAGE SALE

**SATURDAY AND SUNDAY, JUNE 22 & 23 - 9:00 A.M. - 3:00 P.M.**



Orange Village residents are invited to participate in our Community-Wide Garage Sale. The sale will be at your home. You may participate on one or both days. Please register on our website at [www.orangevillage.com](http://www.orangevillage.com) or by calling Village Hall at 440-498-4400. Please include your address, dates you plan to hold your sale and the items you will have for sale by June 14. Yard signs are available to the first 25 registrants. There is no fee to participate.

Orange Village will publicize the event and provide a participation list on our website and at Village Hall which includes your address and the listing of items you have for sale **ONLY**. Your home can also be identified by placing balloons on your mailbox.

## Donate Your Used Items Kiwanis Club of Lander Circle

If you have items left over from your garage sale or you are just cleaning out your home, contact the Kiwanis Club of Lander Circle to donate your lightly used or new items for their annual rummage sale that is held in July.

**They will not accept** OLD TELEVISIONS, MATTRESSES OR ENCYCLOPEDIAS.

Visit their website at [www.landercirclekiwanis.com](http://www.landercirclekiwanis.com).



## Retire American Flags

Orange Village Service Department provides residents with a bin to retire your American Flags.

You may drop your flags off during our Household Hazardous Waste/Computer Collection day on the first Friday of every month from 7:00 a.m. to 3:00 p.m. at the Service Department, 4680 Lander Road. Please place the flags in the specially marked container and they will be respectfully retired as stipulated in the time-honored code.

## How To Dispose of Latex Paint

Orange Village does **not** accept latex paint in the Household Hazardous Waste Disposal Program because it is not a hazardous material. Latex paint is comprised 99% water and 1% rubber and can be safely disposed of in your household trash **when it is dried out**. Listed below are ways to solidify latex paint:



- **Air dry.** Remove the lid and allow the liquid to evaporate. This works well for small quantities of paint (an inch or two in the bottom of the can), and can take several days.

- **Use a drying agent.** Mix an equal amount of an absorbent material into the can and allow the paint to dry. Use cat litter, sawdust, plaster of Paris, Oil-dry, or "waste paint hardeners" found at home improvement centers. The paint could dry quickly, depending on how much drying agent you include in the can.

- **Pour thin layers** (about 1" of paint) into a cardboard box lined with plastic. Allow the paint to dry one layer at a time until all paint has hardened.

Once the paint is thoroughly dry, place it next to your trash container, with the lid off, for Monday trash collection.

# June 2024

ALL ACTIVITIES ARE LOCATED AT ORANGE VILLAGE HALL  
4600 LANDER ROAD, UNLESS OTHERWISE NOTED  
BD - Building Department and SD - Service Department  
located at 4680 Lander Rd.

| Sunday   | Monday  | Tuesday                               | Wednesday   | Thursday  | Friday  | Saturday   |   |  |  |  |   |   |   |   |   |   |   |   |   |    |    |    |    |    |    |    |    |    |    |    |    |    |    |    |    |    |    |    |    |    |    |  |   |   |   |   |   |   |   |   |  |   |   |   |   |   |   |   |   |   |    |    |    |    |    |    |    |    |    |    |    |    |    |    |    |    |    |    |    |    |    |    |  |  |  |  |  |  |  |   |
|--|---|---------------------------------------|---|---|---|--|---|--|--|--|---|---|---|---|---|---|---|---|---|----|----|----|----|----|----|----|----|----|----|----|----|----|----|----|----|----|----|----|----|----|----|--|---|---|---|---|---|---|---|---|--|---|---|---|---|---|---|---|---|---|----|----|----|----|----|----|----|----|----|----|----|----|----|----|----|----|----|----|----|----|----|----|--|--|--|--|--|--|--|---|
| <div>May 2024</div> <table> <tr><td>S</td><td>M</td><td>T</td><td>W</td><td>T</td><td>F</td><td>S</td></tr> <tr><td></td><td></td><td></td><td>1</td><td>2</td><td>3</td><td>4</td></tr> <tr><td>5</td><td>6</td><td>7</td><td>8</td><td>9</td><td>10</td><td>11</td></tr> <tr><td>12</td><td>13</td><td>14</td><td>15</td><td>16</td><td>17</td><td>18</td></tr> <tr><td>19</td><td>20</td><td>21</td><td>22</td><td>23</td><td>24</td><td>25</td></tr> <tr><td>26</td><td>27</td><td>28</td><td>29</td><td>30</td><td>31</td><td></td></tr> </table> | S   | M                                     | T   | W   | T   | F  | S |  |  |  | 1 | 2 | 3 | 4 | 5 | 6 | 7 | 8 | 9 | 10 | 11 | 12 | 13 | 14 | 15 | 16 | 17 | 18 | 19 | 20 | 21 | 22 | 23 | 24 | 25 | 26 | 27 | 28 | 29 | 30 | 31 |  | <div>July 2024</div> <table> <tr><td>S</td><td>M</td><td>T</td><td>W</td><td>T</td><td>F</td><td>S</td></tr> <tr><td></td><td>1</td><td>2</td><td>3</td><td>4</td><td>5</td><td>6</td></tr> <tr><td>7</td><td>8</td><td>9</td><td>10</td><td>11</td><td>12</td><td>13</td></tr> <tr><td>14</td><td>15</td><td>16</td><td>17</td><td>18</td><td>19</td><td>20</td></tr> <tr><td>21</td><td>22</td><td>23</td><td>24</td><td>25</td><td>26</td><td>27</td></tr> <tr><td>28</td><td>29</td><td>30</td><td>31</td><td></td><td></td><td></td></tr> </table> | S | M | T | W | T | F | S |  | 1 | 2 | 3 | 4 | 5 | 6 | 7 | 8 | 9 | 10 | 11 | 12 | 13 | 14 | 15 | 16 | 17 | 18 | 19 | 20 | 21 | 22 | 23 | 24 | 25 | 26 | 27 | 28 | 29 | 30 | 31 |  |  |  |  |  |  |  | 1 |
| S  | M   | T                                     | W   | T   | F   | S  |   |  |  |  |   |   |   |   |   |   |   |   |   |    |    |    |    |    |    |    |    |    |    |    |    |    |    |    |    |    |    |    |    |    |    |  |   |   |   |   |   |   |   |   |  |   |   |   |   |   |   |   |   |   |    |    |    |    |    |    |    |    |    |    |    |    |    |    |    |    |    |    |    |    |    |    |  |  |  |  |  |  |  |   |
|  |   |                                       | 1   | 2   | 3   | 4  |   |  |  |  |   |   |   |   |   |   |   |   |   |    |    |    |    |    |    |    |    |    |    |    |    |    |    |    |    |    |    |    |    |    |    |  |   |   |   |   |   |   |   |   |  |   |   |   |   |   |   |   |   |   |    |    |    |    |    |    |    |    |    |    |    |    |    |    |    |    |    |    |    |    |    |    |  |  |  |  |  |  |  |   |
| 5  | 6   | 7                                     | 8   | 9   | 10  | 11   |   |  |  |  |   |   |   |   |   |   |   |   |   |    |    |    |    |    |    |    |    |    |    |    |    |    |    |    |    |    |    |    |    |    |    |  |   |   |   |   |   |   |   |   |  |   |   |   |   |   |   |   |   |   |    |    |    |    |    |    |    |    |    |    |    |    |    |    |    |    |    |    |    |    |    |    |  |  |  |  |  |  |  |   |
| 12   | 13  | 14                                    | 15  | 16  | 17  | 18   |   |  |  |  |   |   |   |   |   |   |   |   |   |    |    |    |    |    |    |    |    |    |    |    |    |    |    |    |    |    |    |    |    |    |    |  |   |   |   |   |   |   |   |   |  |   |   |   |   |   |   |   |   |   |    |    |    |    |    |    |    |    |    |    |    |    |    |    |    |    |    |    |    |    |    |    |  |  |  |  |  |  |  |   |
| 19   | 20  | 21                                    | 22  | 23  | 24  | 25   |   |  |  |  |   |   |   |   |   |   |   |   |   |    |    |    |    |    |    |    |    |    |    |    |    |    |    |    |    |    |    |    |    |    |    |  |   |   |   |   |   |   |   |   |  |   |   |   |   |   |   |   |   |   |    |    |    |    |    |    |    |    |    |    |    |    |    |    |    |    |    |    |    |    |    |    |  |  |  |  |  |  |  |   |
| 26   | 27  | 28                                    | 29  | 30  | 31  |  |   |  |  |  |   |   |   |   |   |   |   |   |   |    |    |    |    |    |    |    |    |    |    |    |    |    |    |    |    |    |    |    |    |    |    |  |   |   |   |   |   |   |   |   |  |   |   |   |   |   |   |   |   |   |    |    |    |    |    |    |    |    |    |    |    |    |    |    |    |    |    |    |    |    |    |    |  |  |  |  |  |  |  |   |
| S  | M   | T                                     | W   | T   | F   | S  |   |  |  |  |   |   |   |   |   |   |   |   |   |    |    |    |    |    |    |    |    |    |    |    |    |    |    |    |    |    |    |    |    |    |    |  |   |   |   |   |   |   |   |   |  |   |   |   |   |   |   |   |   |   |    |    |    |    |    |    |    |    |    |    |    |    |    |    |    |    |    |    |    |    |    |    |  |  |  |  |  |  |  |   |
|  | 1   | 2                                     | 3   | 4   | 5   | 6  |   |  |  |  |   |   |   |   |   |   |   |   |   |    |    |    |    |    |    |    |    |    |    |    |    |    |    |    |    |    |    |    |    |    |    |  |   |   |   |   |   |   |   |   |  |   |   |   |   |   |   |   |   |   |    |    |    |    |    |    |    |    |    |    |    |    |    |    |    |    |    |    |    |    |    |    |  |  |  |  |  |  |  |   |
| 7  | 8   | 9                                     | 10  | 11  | 12  | 13   |   |  |  |  |   |   |   |   |   |   |   |   |   |    |    |    |    |    |    |    |    |    |    |    |    |    |    |    |    |    |    |    |    |    |    |  |   |   |   |   |   |   |   |   |  |   |   |   |   |   |   |   |   |   |    |    |    |    |    |    |    |    |    |    |    |    |    |    |    |    |    |    |    |    |    |    |  |  |  |  |  |  |  |   |
| 14   | 15  | 16                                    | 17  | 18  | 19  | 20   |   |  |  |  |   |   |   |   |   |   |   |   |   |    |    |    |    |    |    |    |    |    |    |    |    |    |    |    |    |    |    |    |    |    |    |  |   |   |   |   |   |   |   |   |  |   |   |   |   |   |   |   |   |   |    |    |    |    |    |    |    |    |    |    |    |    |    |    |    |    |    |    |    |    |    |    |  |  |  |  |  |  |  |   |
| 21   | 22  | 23                                    | 24  | 25  | 26  | 27   |   |  |  |  |   |   |   |   |   |   |   |   |   |    |    |    |    |    |    |    |    |    |    |    |    |    |    |    |    |    |    |    |    |    |    |  |   |   |   |   |   |   |   |   |  |   |   |   |   |   |   |   |   |   |    |    |    |    |    |    |    |    |    |    |    |    |    |    |    |    |    |    |    |    |    |    |  |  |  |  |  |  |  |   |
| 28   | 29  | 30                                    | 31  |   |   |  |   |  |  |  |   |   |   |   |   |   |   |   |   |    |    |    |    |    |    |    |    |    |    |    |    |    |    |    |    |    |    |    |    |    |    |  |   |   |   |   |   |   |   |   |  |   |   |   |   |   |   |   |   |   |    |    |    |    |    |    |    |    |    |    |    |    |    |    |    |    |    |    |    |    |    |    |  |  |  |  |  |  |  |   |
| 2  | 3   | 4                                     | 5   | 6   | Computer, Flags<br>Household Hazardous<br>Waste Collection<br>7 a.m. - 3 p.m. - SD<br>Paper Shredding<br>Orange Village SD<br>9:00 a.m. - noon<br>5 bag limit | 8  |   |  |  |  |   |   |   |   |   |   |   |   |   |    |    |    |    |    |    |    |    |    |    |    |    |    |    |    |    |    |    |    |    |    |    |  |   |   |   |   |   |   |   |   |  |   |   |   |   |   |   |   |   |   |    |    |    |    |    |    |    |    |    |    |    |    |    |    |    |    |    |    |    |    |    |    |  |  |  |  |  |  |  |   |
|  | Trash/Recycling<br>Pick up  | Planning & Zoning<br>ABR Meeting - BD | Council Work<br>Session/Special<br>Meeting  | Orange<br>Schools<br>Last Day   |   |  |   |  |  |  |   |   |   |   |   |   |   |   |   |    |    |    |    |    |    |    |    |    |    |    |    |    |    |    |    |    |    |    |    |    |    |  |   |   |   |   |   |   |   |   |  |   |   |   |   |   |   |   |   |   |    |    |    |    |    |    |    |    |    |    |    |    |    |    |    |    |    |    |    |    |    |    |  |  |  |  |  |  |  |   |
| 9  |  Branch Chipping<br>Trash/Recycling<br>Pick up | 11                                    |  Finance Meeting<br>Council Meeting | 13  |  FLAG DAY   | 15   |   |  |  |  |   |   |   |   |   |   |   |   |   |    |    |    |    |    |    |    |    |    |    |    |    |    |    |    |    |    |    |    |    |    |    |  |   |   |   |   |   |   |   |   |  |   |   |   |   |   |   |   |   |   |    |    |    |    |    |    |    |    |    |    |    |    |    |    |    |    |    |    |    |    |    |    |  |  |  |  |  |  |  |   |
|  |   | Shavuot begins<br>at sundown          |   |   |   |  |   |  |  |  |   |   |   |   |   |   |   |   |   |    |    |    |    |    |    |    |    |    |    |    |    |    |    |    |    |    |    |    |    |    |    |  |   |   |   |   |   |   |   |   |  |   |   |   |   |   |   |   |   |   |    |    |    |    |    |    |    |    |    |    |    |    |    |    |    |    |    |    |    |    |    |    |  |  |  |  |  |  |  |   |
| 16   | 17  | 18                                    | 19  | 20  | 21  |  Community Wide<br>Garage Sale<br>9 a.m.-3 p.m. |   |  |  |  |   |   |   |   |   |   |   |   |   |    |    |    |    |    |    |    |    |    |    |    |    |    |    |    |    |    |    |    |    |    |    |  |   |   |   |   |   |   |   |   |  |   |   |   |   |   |   |   |   |   |    |    |    |    |    |    |    |    |    |    |    |    |    |    |    |    |    |    |    |    |    |    |  |  |  |  |  |  |  |   |
|  Community<br>Wide Garage<br>Sale<br>9 a.m.-3 p.m.   | Trash/Recycling<br>Pick up  | Planning & Zoning<br>ABR Meeting - BD |  JUNETEENTH<br>FREEDOM DAY        |  First<br>Day of<br>SUMMER |   |  |   |  |  |  |   |   |   |   |   |   |   |   |   |    |    |    |    |    |    |    |    |    |    |    |    |    |    |    |    |    |    |    |    |    |    |  |   |   |   |   |   |   |   |   |  |   |   |   |   |   |   |   |   |   |    |    |    |    |    |    |    |    |    |    |    |    |    |    |    |    |    |    |    |    |    |    |  |  |  |  |  |  |  |   |
| 23   | 24  | 25                                    | 26  | 27  | 28  | 29   |   |  |  |  |   |   |   |   |   |   |   |   |   |    |    |    |    |    |    |    |    |    |    |    |    |    |    |    |    |    |    |    |    |    |    |  |   |   |   |   |   |   |   |   |  |   |   |   |   |   |   |   |   |   |    |    |    |    |    |    |    |    |    |    |    |    |    |    |    |    |    |    |    |    |    |    |  |  |  |  |  |  |  |   |
| 30   | Trash/Recycling<br>Pick up  |                                       |   |   |   |  |   |  |  |  |   |   |   |   |   |   |   |   |   |    |    |    |    |    |    |    |    |    |    |    |    |    |    |    |    |    |    |    |    |    |    |  |   |   |   |   |   |   |   |   |  |   |   |   |   |   |   |   |   |   |    |    |    |    |    |    |    |    |    |    |    |    |    |    |    |    |    |    |    |    |    |    |  |  |  |  |  |  |  |   |



***Join us as we celebrate our park at our***

**Party in the Park  
Saturday, July 20  
beginning at 6:00 p.m.**

Let's get together and enjoy all the wonderful amenities our park has to offer. Enjoy a ride on the Euclid Beach Rocketship Car, jump and play on the inflatables or at the playground. Food trucks will be available to purchase dinner or snacks. The evening will conclude with fireworks!



## **Medicine Disposal - Rx Drug Drop Box Program**



Orange Village Police Department and Cuyahoga County are working to protect your home and the environment from potentially dangerous medications with the Rx Drug Drop Box Program.

Law enforcement is the only entity legally able to accept these medications and process them properly so that they do not fall into the wrong hands. Law enforcement takes control of and destroys drugs on a regular basis as part of their ongoing operations.

The RX Drug Drop Box Program is an opportunity for residents to deposit unused, unwanted, or expired prescription drugs. You may drop off your items Monday through Friday from 8:30 am to 4:00 pm at Orange Police Department, 4600 Lander Road. Needles and liquids cannot be accepted.



## **CANS FOR BURNED CHILDREN**

Orange Village Fire Department collects aluminum beverage cans for recycling. All profits benefit the Aluminum Cans for Burned Children Foundation.

In 1986 the Northern Ohio Fire Fighters and the Northeast Fire Chiefs' Association, along with Metro Health Medical Center of Cleveland began the Aluminum Cans for Burned Children Foundation (ACBC) to help children who suffered severe burn injuries.

If you would like to separate these cans from your other recyclables, please deposit them in the recycle bins located on the south entrance to Village Hall by the Fire Station, 4600 Lander Road.



Visit our website at [www.orangevillage.com](http://www.orangevillage.com) for more information on recycling and other Village services.

# July 2024

ALL ACTIVITIES ARE LOCATED AT ORANGE VILLAGE HALL  
4600 LANDER ROAD, UNLESS OTHERWISE NOTED  
BD - Building Department and SD - Service Department  
located at 4680 Lander Rd.

| Sunday | Monday   | Tuesday  | Wednesday  | Thursday  | Friday   | Saturday  |   |   |   |   |   |   |  |  |  |  |  |  |   |   |   |   |   |   |   |   |   |    |    |    |    |    |    |    |    |    |    |    |    |    |    |    |    |    |    |    |    |    |  |  |  |  |  |  |  |   |   |   |   |   |   |   |  |  |  |  |   |   |   |   |   |   |   |   |   |    |    |    |    |    |    |    |    |    |    |    |    |    |    |    |    |    |    |    |    |    |    |  |  |  |  |  |  |  |
|--------|--|--|--|---|--|---|---|---|---|---|---|---|--|--|--|--|--|--|---|---|---|---|---|---|---|---|---|----|----|----|----|----|----|----|----|----|----|----|----|----|----|----|----|----|----|----|----|----|--|--|--|--|--|--|--|---|---|---|---|---|---|---|--|--|--|--|---|---|---|---|---|---|---|---|---|----|----|----|----|----|----|----|----|----|----|----|----|----|----|----|----|----|----|----|----|----|----|--|--|--|--|--|--|--|
|        | 1<br><div>Trash/Recycling Pick up</div>  | 2<br><div>Planning &amp; Zoning ABR Meeting - BD</div>   | 3<br><div>Council Work Session/Special Meeting</div> | 4<br><div><div>Village Hall Closed</div></div> | 5<br><div><div>Computer, Flags &amp; Household Hazardous Waste Collection<br/>7 a.m. - 3 p.m. - SD</div></div>  | 6   |   |   |   |   |   |   |  |  |  |  |  |  |   |   |   |   |   |   |   |   |   |    |    |    |    |    |    |    |    |    |    |    |    |    |    |    |    |    |    |    |    |    |  |  |  |  |  |  |  |   |   |   |   |   |   |   |  |  |  |  |   |   |   |   |   |   |   |   |   |    |    |    |    |    |    |    |    |    |    |    |    |    |    |    |    |    |    |    |    |    |    |  |  |  |  |  |  |  |
| 7      | 8<br><div>Trash/Recycling Pick up</div>  | 9  | 10<br><div>Finance Meeting<br/>Council Meeting</div> | 11  | 12   | 13  |   |   |   |   |   |   |  |  |  |  |  |  |   |   |   |   |   |   |   |   |   |    |    |    |    |    |    |    |    |    |    |    |    |    |    |    |    |    |    |    |    |    |  |  |  |  |  |  |  |   |   |   |   |   |   |   |  |  |  |  |   |   |   |   |   |   |   |   |   |    |    |    |    |    |    |    |    |    |    |    |    |    |    |    |    |    |    |    |    |    |    |  |  |  |  |  |  |  |
| 14     | 15<br><div>Trash/Recycling Pick up</div>   | 16<br><div>Planning &amp; Zoning ABR Meeting - BD.</div> | 17   | 18  | 19   | 20<br><div><div>begins at 6:00 p.m.</div></div> |   |   |   |   |   |   |  |  |  |  |  |  |   |   |   |   |   |   |   |   |   |    |    |    |    |    |    |    |    |    |    |    |    |    |    |    |    |    |    |    |    |    |  |  |  |  |  |  |  |   |   |   |   |   |   |   |  |  |  |  |   |   |   |   |   |   |   |   |   |    |    |    |    |    |    |    |    |    |    |    |    |    |    |    |    |    |    |    |    |    |    |  |  |  |  |  |  |  |
| 21     | 22<br><div><div>Branch Chipping</div><div>Trash/Recycling Pick up</div></div> | 23   | 24   | 25  | 26   | 27  |   |   |   |   |   |   |  |  |  |  |  |  |   |   |   |   |   |   |   |   |   |    |    |    |    |    |    |    |    |    |    |    |    |    |    |    |    |    |    |    |    |    |  |  |  |  |  |  |  |   |   |   |   |   |   |   |  |  |  |  |   |   |   |   |   |   |   |   |   |    |    |    |    |    |    |    |    |    |    |    |    |    |    |    |    |    |    |    |    |    |    |  |  |  |  |  |  |  |
| 28     | 29<br><div>Trash/Recycling Pick up</div>   | 30   | 31   |   | <div>June 2024</div> <table><tr><td>S</td><td>M</td><td>T</td><td>W</td><td>T</td><td>F</td><td>S</td></tr><tr><td></td><td></td><td></td><td></td><td></td><td></td><td>1</td></tr><tr><td>2</td><td>3</td><td>4</td><td>5</td><td>6</td><td>7</td><td>8</td></tr><tr><td>9</td><td>10</td><td>11</td><td>12</td><td>13</td><td>14</td><td>15</td></tr><tr><td>16</td><td>17</td><td>18</td><td>19</td><td>20</td><td>21</td><td>22</td></tr><tr><td>23</td><td>24</td><td>25</td><td>26</td><td>27</td><td>28</td><td>29</td></tr><tr><td>30</td><td></td><td></td><td></td><td></td><td></td><td></td></tr></table> | S   | M | T | W | T | F | S |  |  |  |  |  |  | 1 | 2 | 3 | 4 | 5 | 6 | 7 | 8 | 9 | 10 | 11 | 12 | 13 | 14 | 15 | 16 | 17 | 18 | 19 | 20 | 21 | 22 | 23 | 24 | 25 | 26 | 27 | 28 | 29 | 30 |  |  |  |  |  |  | <div>August 2024</div> <table><tr><td>S</td><td>M</td><td>T</td><td>W</td><td>T</td><td>F</td><td>S</td></tr><tr><td></td><td></td><td></td><td></td><td>1</td><td>2</td><td>3</td></tr><tr><td>4</td><td>5</td><td>6</td><td>7</td><td>8</td><td>9</td><td>10</td></tr><tr><td>11</td><td>12</td><td>13</td><td>14</td><td>15</td><td>16</td><td>17</td></tr><tr><td>18</td><td>19</td><td>20</td><td>21</td><td>22</td><td>23</td><td>24</td></tr><tr><td>25</td><td>26</td><td>27</td><td>28</td><td>29</td><td>30</td><td>31</td></tr><tr><td></td><td></td><td></td><td></td><td></td><td></td><td></td></tr></table> | S | M | T | W | T | F | S |  |  |  |  | 1 | 2 | 3 | 4 | 5 | 6 | 7 | 8 | 9 | 10 | 11 | 12 | 13 | 14 | 15 | 16 | 17 | 18 | 19 | 20 | 21 | 22 | 23 | 24 | 25 | 26 | 27 | 28 | 29 | 30 | 31 |  |  |  |  |  |  |  |
| S      | M  | T  | W  | T   | F  | S   |   |   |   |   |   |   |  |  |  |  |  |  |   |   |   |   |   |   |   |   |   |    |    |    |    |    |    |    |    |    |    |    |    |    |    |    |    |    |    |    |    |    |  |  |  |  |  |  |  |   |   |   |   |   |   |   |  |  |  |  |   |   |   |   |   |   |   |   |   |    |    |    |    |    |    |    |    |    |    |    |    |    |    |    |    |    |    |    |    |    |    |  |  |  |  |  |  |  |
|        |  |  |  |   |  | 1   |   |   |   |   |   |   |  |  |  |  |  |  |   |   |   |   |   |   |   |   |   |    |    |    |    |    |    |    |    |    |    |    |    |    |    |    |    |    |    |    |    |    |  |  |  |  |  |  |  |   |   |   |   |   |   |   |  |  |  |  |   |   |   |   |   |   |   |   |   |    |    |    |    |    |    |    |    |    |    |    |    |    |    |    |    |    |    |    |    |    |    |  |  |  |  |  |  |  |
| 2      | 3  | 4  | 5  | 6   | 7  | 8   |   |   |   |   |   |   |  |  |  |  |  |  |   |   |   |   |   |   |   |   |   |    |    |    |    |    |    |    |    |    |    |    |    |    |    |    |    |    |    |    |    |    |  |  |  |  |  |  |  |   |   |   |   |   |   |   |  |  |  |  |   |   |   |   |   |   |   |   |   |    |    |    |    |    |    |    |    |    |    |    |    |    |    |    |    |    |    |    |    |    |    |  |  |  |  |  |  |  |
| 9      | 10   | 11   | 12   | 13  | 14   | 15  |   |   |   |   |   |   |  |  |  |  |  |  |   |   |   |   |   |   |   |   |   |    |    |    |    |    |    |    |    |    |    |    |    |    |    |    |    |    |    |    |    |    |  |  |  |  |  |  |  |   |   |   |   |   |   |   |  |  |  |  |   |   |   |   |   |   |   |   |   |    |    |    |    |    |    |    |    |    |    |    |    |    |    |    |    |    |    |    |    |    |    |  |  |  |  |  |  |  |
| 16     | 17   | 18   | 19   | 20  | 21   | 22  |   |   |   |   |   |   |  |  |  |  |  |  |   |   |   |   |   |   |   |   |   |    |    |    |    |    |    |    |    |    |    |    |    |    |    |    |    |    |    |    |    |    |  |  |  |  |  |  |  |   |   |   |   |   |   |   |  |  |  |  |   |   |   |   |   |   |   |   |   |    |    |    |    |    |    |    |    |    |    |    |    |    |    |    |    |    |    |    |    |    |    |  |  |  |  |  |  |  |
| 23     | 24   | 25   | 26   | 27  | 28   | 29  |   |   |   |   |   |   |  |  |  |  |  |  |   |   |   |   |   |   |   |   |   |    |    |    |    |    |    |    |    |    |    |    |    |    |    |    |    |    |    |    |    |    |  |  |  |  |  |  |  |   |   |   |   |   |   |   |  |  |  |  |   |   |   |   |   |   |   |   |   |    |    |    |    |    |    |    |    |    |    |    |    |    |    |    |    |    |    |    |    |    |    |  |  |  |  |  |  |  |
| 30     |  |  |  |   |  |   |   |   |   |   |   |   |  |  |  |  |  |  |   |   |   |   |   |   |   |   |   |    |    |    |    |    |    |    |    |    |    |    |    |    |    |    |    |    |    |    |    |    |  |  |  |  |  |  |  |   |   |   |   |   |   |   |  |  |  |  |   |   |   |   |   |   |   |   |   |    |    |    |    |    |    |    |    |    |    |    |    |    |    |    |    |    |    |    |    |    |    |  |  |  |  |  |  |  |
| S      | M  | T  | W  | T   | F  | S   |   |   |   |   |   |   |  |  |  |  |  |  |   |   |   |   |   |   |   |   |   |    |    |    |    |    |    |    |    |    |    |    |    |    |    |    |    |    |    |    |    |    |  |  |  |  |  |  |  |   |   |   |   |   |   |   |  |  |  |  |   |   |   |   |   |   |   |   |   |    |    |    |    |    |    |    |    |    |    |    |    |    |    |    |    |    |    |    |    |    |    |  |  |  |  |  |  |  |
|        |  |  |  | 1   | 2  | 3   |   |   |   |   |   |   |  |  |  |  |  |  |   |   |   |   |   |   |   |   |   |    |    |    |    |    |    |    |    |    |    |    |    |    |    |    |    |    |    |    |    |    |  |  |  |  |  |  |  |   |   |   |   |   |   |   |  |  |  |  |   |   |   |   |   |   |   |   |   |    |    |    |    |    |    |    |    |    |    |    |    |    |    |    |    |    |    |    |    |    |    |  |  |  |  |  |  |  |
| 4      | 5  | 6  | 7  | 8   | 9  | 10  |   |   |   |   |   |   |  |  |  |  |  |  |   |   |   |   |   |   |   |   |   |    |    |    |    |    |    |    |    |    |    |    |    |    |    |    |    |    |    |    |    |    |  |  |  |  |  |  |  |   |   |   |   |   |   |   |  |  |  |  |   |   |   |   |   |   |   |   |   |    |    |    |    |    |    |    |    |    |    |    |    |    |    |    |    |    |    |    |    |    |    |  |  |  |  |  |  |  |
| 11     | 12   | 13   | 14   | 15  | 16   | 17  |   |   |   |   |   |   |  |  |  |  |  |  |   |   |   |   |   |   |   |   |   |    |    |    |    |    |    |    |    |    |    |    |    |    |    |    |    |    |    |    |    |    |  |  |  |  |  |  |  |   |   |   |   |   |   |   |  |  |  |  |   |   |   |   |   |   |   |   |   |    |    |    |    |    |    |    |    |    |    |    |    |    |    |    |    |    |    |    |    |    |    |  |  |  |  |  |  |  |
| 18     | 19   | 20   | 21   | 22  | 23   | 24  |   |   |   |   |   |   |  |  |  |  |  |  |   |   |   |   |   |   |   |   |   |    |    |    |    |    |    |    |    |    |    |    |    |    |    |    |    |    |    |    |    |    |  |  |  |  |  |  |  |   |   |   |   |   |   |   |  |  |  |  |   |   |   |   |   |   |   |   |   |    |    |    |    |    |    |    |    |    |    |    |    |    |    |    |    |    |    |    |    |    |    |  |  |  |  |  |  |  |
| 25     | 26   | 27   | 28   | 29  | 30   | 31  |   |   |   |   |   |   |  |  |  |  |  |  |   |   |   |   |   |   |   |   |   |    |    |    |    |    |    |    |    |    |    |    |    |    |    |    |    |    |    |    |    |    |  |  |  |  |  |  |  |   |   |   |   |   |   |   |  |  |  |  |   |   |   |   |   |   |   |   |   |    |    |    |    |    |    |    |    |    |    |    |    |    |    |    |    |    |    |    |    |    |    |  |  |  |  |  |  |  |
|        |  |  |  |   |  |   |   |   |   |   |   |   |  |  |  |  |  |  |   |   |   |   |   |   |   |   |   |    |    |    |    |    |    |    |    |    |    |    |    |    |    |    |    |    |    |    |    |    |  |  |  |  |  |  |  |   |   |   |   |   |   |   |  |  |  |  |   |   |   |   |   |   |   |   |   |    |    |    |    |    |    |    |    |    |    |    |    |    |    |    |    |    |    |    |    |    |    |  |  |  |  |  |  |  |

## Storm Sewers and Sanitary Sewers

Two types of sewer systems in Orange Village serve residents and businesses: storm and sanitary.

A storm sewer carries rainfall runoff and other drainage that is outside of your home. Gutters, pond overflows, and footer/foundation drains carry untreated water to local streams, rivers, and other surface bodies of water.

A sanitary sewer is a system of underground pipes that carries sewage from bathrooms, kitchens and other plumbing components to a wastewater treatment plant where it is filtered, treated, and discharged as clean water. Floor drains in garages and basements are part of a sanitary sewer.

Some parts of Orange Village still have septic systems, which are like private sewage treatment plants. The sewage drains into a septic holding tank, where solids collect and water is separated out and put into a second tank, which discharges the water.

Here are tips for helping your sewage system work properly:

- Chemicals or hazardous substances should NEVER be put into a storm sewer system.
- Never tie gutter drains or yard drains to a sanitary or septic system.
- Periodically have your gutters and septic systems cleaned and inspected.
- Never tie or “cross connect” a storm sewer and sanitary sewer.

For more details about sewage systems, go to <https://www.orangevillage.com/service-department/>.

## Managing stormwater on your property

Simple steps around your home can have big benefits in your yard. On-site stormwater management helps protect water quality and reduce flooding and erosion, but having a comprehensive list of common best practices can be overwhelming.

Cuyahoga Soil & Water Conservation District offers rain barrel workshops and rain garden advice.

### *Building a Rain Barrel*

#### What is a Rain Barrel?

A rain barrel is a container used to collect and store rainwater that would otherwise be lost to runoff and likely diverted to a storm drain. Collected water may then be used to water lawns and gardens. Rainwater can be harvested in many ways. The catchment system described here is just one way to capture rainwater for use in your yard.



Cuyahoga Soil & Water Conservation District offers annual workshops along with many recommendations and resources for making rain barrels for your property.

## CFL Bulbs and Fluorescent Tubes



Compact fluorescent lamps and other energy-efficient lighting contain a very small amount of mercury. While mercury is a useful element with many applications, it can pose a threat to human health and the environment if thrown in the trash or flushed down a sink. All fluorescent bulbs should be recycled properly to protect public health and the environment. The Home Depot® and Lowe's Home Improvement offer **free in-store** recycling of consumer compact fluorescent light (CFL) bulbs, rechargeable batteries, and plastic bags in their stores.

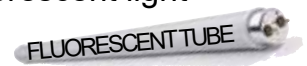

Fluorescent tubes can be recycled at Batteries Plus stores, for a nominal fee per tube (\$.96 for tubes less than 4 feet and \$1.96 for 4-8 foot tubes). Residents may also contact Cuyahoga County Solid Waste District at (216) 443-3749 for alternate disposal options.

# August 2024

ALL ACTIVITIES ARE LOCATED AT ORANGE VILLAGE HALL  
4600 LANDER ROAD, UNLESS OTHERWISE NOTED  
BD - Building Department and SD - Service Department  
located at 4680 Lander Rd.

| Sunday  | Monday                  | Tuesday                            | Wednesday                            | Thursday | Friday  | Saturday |   |  |   |   |   |   |   |   |   |   |   |    |    |    |    |    |    |    |    |    |    |    |    |    |    |    |    |    |    |    |    |    |    |  |  |  |  |   |   |   |   |   |   |   |   |   |   |   |   |   |   |   |   |    |    |    |    |    |    |    |    |    |    |    |    |    |    |    |    |    |    |    |    |    |  |  |  |  |  |  |  |  |   |          |
|---|-------------------------|------------------------------------|--------------------------------------|----------|---|----------|---|--|---|---|---|---|---|---|---|---|---|----|----|----|----|----|----|----|----|----|----|----|----|----|----|----|----|----|----|----|----|----|----|--|--|--|--|---|---|---|---|---|---|---|---|---|---|---|---|---|---|---|---|----|----|----|----|----|----|----|----|----|----|----|----|----|----|----|----|----|----|----|----|----|--|--|--|--|--|--|--|--|---|----------|
| <p>July 2024</p> <table> <tr><td>S</td><td>M</td><td>T</td><td>W</td><td>T</td><td>F</td><td>S</td></tr> <tr><td></td><td>1</td><td>2</td><td>3</td><td>4</td><td>5</td><td>6</td></tr> <tr><td>7</td><td>8</td><td>9</td><td>10</td><td>11</td><td>12</td><td>13</td></tr> <tr><td>14</td><td>15</td><td>16</td><td>17</td><td>18</td><td>19</td><td>20</td></tr> <tr><td>21</td><td>22</td><td>23</td><td>24</td><td>25</td><td>26</td><td>27</td></tr> <tr><td>28</td><td>29</td><td>30</td><td>31</td><td></td><td></td><td></td></tr> </table> | S                       | M                                  | T                                    | W        | T   | F        | S |  | 1 | 2 | 3 | 4 | 5 | 6 | 7 | 8 | 9 | 10 | 11 | 12 | 13 | 14 | 15 | 16 | 17 | 18 | 19 | 20 | 21 | 22 | 23 | 24 | 25 | 26 | 27 | 28 | 29 | 30 | 31 |  |  |  | <p>September 2024</p> <table> <tr><td>S</td><td>M</td><td>T</td><td>W</td><td>T</td><td>F</td><td>S</td></tr> <tr><td>1</td><td>2</td><td>3</td><td>4</td><td>5</td><td>6</td><td>7</td></tr> <tr><td>8</td><td>9</td><td>10</td><td>11</td><td>12</td><td>13</td><td>14</td></tr> <tr><td>15</td><td>16</td><td>17</td><td>18</td><td>19</td><td>20</td><td>21</td></tr> <tr><td>22</td><td>23</td><td>24</td><td>25</td><td>26</td><td>27</td><td>28</td></tr> <tr><td>29</td><td>30</td><td></td><td></td><td></td><td></td><td></td></tr> </table> | S | M | T | W | T | F | S | 1 | 2 | 3 | 4 | 5 | 6 | 7 | 8 | 9 | 10 | 11 | 12 | 13 | 14 | 15 | 16 | 17 | 18 | 19 | 20 | 21 | 22 | 23 | 24 | 25 | 26 | 27 | 28 | 29 | 30 |  |  |  |  |  |  |  |  <p>1</p> |  <p>2</p> <p>Computer, Flags &amp; Household Hazardous Waste Collection<br/>7 a.m. - 3 p.m. - SD</p> | <p>3</p> |
| S   | M                       | T                                  | W                                    | T        | F   | S        |   |  |   |   |   |   |   |   |   |   |   |    |    |    |    |    |    |    |    |    |    |    |    |    |    |    |    |    |    |    |    |    |    |  |  |  |  |   |   |   |   |   |   |   |   |   |   |   |   |   |   |   |   |    |    |    |    |    |    |    |    |    |    |    |    |    |    |    |    |    |    |    |    |    |  |  |  |  |  |  |  |  |   |          |
|   | 1                       | 2                                  | 3                                    | 4        | 5   | 6        |   |  |   |   |   |   |   |   |   |   |   |    |    |    |    |    |    |    |    |    |    |    |    |    |    |    |    |    |    |    |    |    |    |  |  |  |  |   |   |   |   |   |   |   |   |   |   |   |   |   |   |   |   |    |    |    |    |    |    |    |    |    |    |    |    |    |    |    |    |    |    |    |    |    |  |  |  |  |  |  |  |  |   |          |
| 7   | 8                       | 9                                  | 10                                   | 11       | 12  | 13       |   |  |   |   |   |   |   |   |   |   |   |    |    |    |    |    |    |    |    |    |    |    |    |    |    |    |    |    |    |    |    |    |    |  |  |  |  |   |   |   |   |   |   |   |   |   |   |   |   |   |   |   |   |    |    |    |    |    |    |    |    |    |    |    |    |    |    |    |    |    |    |    |    |    |  |  |  |  |  |  |  |  |   |          |
| 14  | 15                      | 16                                 | 17                                   | 18       | 19  | 20       |   |  |   |   |   |   |   |   |   |   |   |    |    |    |    |    |    |    |    |    |    |    |    |    |    |    |    |    |    |    |    |    |    |  |  |  |  |   |   |   |   |   |   |   |   |   |   |   |   |   |   |   |   |    |    |    |    |    |    |    |    |    |    |    |    |    |    |    |    |    |    |    |    |    |  |  |  |  |  |  |  |  |   |          |
| 21  | 22                      | 23                                 | 24                                   | 25       | 26  | 27       |   |  |   |   |   |   |   |   |   |   |   |    |    |    |    |    |    |    |    |    |    |    |    |    |    |    |    |    |    |    |    |    |    |  |  |  |  |   |   |   |   |   |   |   |   |   |   |   |   |   |   |   |   |    |    |    |    |    |    |    |    |    |    |    |    |    |    |    |    |    |    |    |    |    |  |  |  |  |  |  |  |  |   |          |
| 28  | 29                      | 30                                 | 31                                   |          |   |          |   |  |   |   |   |   |   |   |   |   |   |    |    |    |    |    |    |    |    |    |    |    |    |    |    |    |    |    |    |    |    |    |    |  |  |  |  |   |   |   |   |   |   |   |   |   |   |   |   |   |   |   |   |    |    |    |    |    |    |    |    |    |    |    |    |    |    |    |    |    |    |    |    |    |  |  |  |  |  |  |  |  |   |          |
| S   | M                       | T                                  | W                                    | T        | F   | S        |   |  |   |   |   |   |   |   |   |   |   |    |    |    |    |    |    |    |    |    |    |    |    |    |    |    |    |    |    |    |    |    |    |  |  |  |  |   |   |   |   |   |   |   |   |   |   |   |   |   |   |   |   |    |    |    |    |    |    |    |    |    |    |    |    |    |    |    |    |    |    |    |    |    |  |  |  |  |  |  |  |  |   |          |
| 1   | 2                       | 3                                  | 4                                    | 5        | 6   | 7        |   |  |   |   |   |   |   |   |   |   |   |    |    |    |    |    |    |    |    |    |    |    |    |    |    |    |    |    |    |    |    |    |    |  |  |  |  |   |   |   |   |   |   |   |   |   |   |   |   |   |   |   |   |    |    |    |    |    |    |    |    |    |    |    |    |    |    |    |    |    |    |    |    |    |  |  |  |  |  |  |  |  |   |          |
| 8   | 9                       | 10                                 | 11                                   | 12       | 13  | 14       |   |  |   |   |   |   |   |   |   |   |   |    |    |    |    |    |    |    |    |    |    |    |    |    |    |    |    |    |    |    |    |    |    |  |  |  |  |   |   |   |   |   |   |   |   |   |   |   |   |   |   |   |   |    |    |    |    |    |    |    |    |    |    |    |    |    |    |    |    |    |    |    |    |    |  |  |  |  |  |  |  |  |   |          |
| 15  | 16                      | 17                                 | 18                                   | 19       | 20  | 21       |   |  |   |   |   |   |   |   |   |   |   |    |    |    |    |    |    |    |    |    |    |    |    |    |    |    |    |    |    |    |    |    |    |  |  |  |  |   |   |   |   |   |   |   |   |   |   |   |   |   |   |   |   |    |    |    |    |    |    |    |    |    |    |    |    |    |    |    |    |    |    |    |    |    |  |  |  |  |  |  |  |  |   |          |
| 22  | 23                      | 24                                 | 25                                   | 26       | 27  | 28       |   |  |   |   |   |   |   |   |   |   |   |    |    |    |    |    |    |    |    |    |    |    |    |    |    |    |    |    |    |    |    |    |    |  |  |  |  |   |   |   |   |   |   |   |   |   |   |   |   |   |   |   |   |    |    |    |    |    |    |    |    |    |    |    |    |    |    |    |    |    |    |    |    |    |  |  |  |  |  |  |  |  |   |          |
| 29  | 30                      |                                    |                                      |          |   |          |   |  |   |   |   |   |   |   |   |   |   |    |    |    |    |    |    |    |    |    |    |    |    |    |    |    |    |    |    |    |    |    |    |  |  |  |  |   |   |   |   |   |   |   |   |   |   |   |   |   |   |   |   |    |    |    |    |    |    |    |    |    |    |    |    |    |    |    |    |    |    |    |    |    |  |  |  |  |  |  |  |  |   |          |
| 4   | 5                       | 6                                  | 7                                    | 8        | 9   | 10       |   |  |   |   |   |   |   |   |   |   |   |    |    |    |    |    |    |    |    |    |    |    |    |    |    |    |    |    |    |    |    |    |    |  |  |  |  |   |   |   |   |   |   |   |   |   |   |   |   |   |   |   |   |    |    |    |    |    |    |    |    |    |    |    |    |    |    |    |    |    |    |    |    |    |  |  |  |  |  |  |  |  |   |          |
|   | Trash/Recycling Pick up | Planning & Zoning ABR Meeting - BD | Council Work Session/Special Meeting |          |   |          |   |  |   |   |   |   |   |   |   |   |   |    |    |    |    |    |    |    |    |    |    |    |    |    |    |    |    |    |    |    |    |    |    |  |  |  |  |   |   |   |   |   |   |   |   |   |   |   |   |   |   |   |   |    |    |    |    |    |    |    |    |    |    |    |    |    |    |    |    |    |    |    |    |    |  |  |  |  |  |  |  |  |   |          |
| 11  | 12                      | 13                                 | 14                                   | 15       | 16  | 17       |   |  |   |   |   |   |   |   |   |   |   |    |    |    |    |    |    |    |    |    |    |    |    |    |    |    |    |    |    |    |    |    |    |  |  |  |  |   |   |   |   |   |   |   |   |   |   |   |   |   |   |   |   |    |    |    |    |    |    |    |    |    |    |    |    |    |    |    |    |    |    |    |    |    |  |  |  |  |  |  |  |  |   |          |
|   | Trash/Recycling Pick up |                                    | Finance Meeting<br>Council Meeting   |          |  <p>Paper Shredding<br/><b>Pepper Pike City Hall, 28000 Shaker</b><br/>9 a.m. - Noon<br/>5 bag limit</p> |          |   |  |   |   |   |   |   |   |   |   |   |    |    |    |    |    |    |    |    |    |    |    |    |    |    |    |    |    |    |    |    |    |    |  |  |  |  |   |   |   |   |   |   |   |   |   |   |   |   |   |   |   |   |    |    |    |    |    |    |    |    |    |    |    |    |    |    |    |    |    |    |    |    |    |  |  |  |  |  |  |  |  |   |          |
| 18  | 19                      | 20                                 | 21                                   | 22       | 23  | 24       |   |  |   |   |   |   |   |   |   |   |   |    |    |    |    |    |    |    |    |    |    |    |    |    |    |    |    |    |    |    |    |    |    |  |  |  |  |   |   |   |   |   |   |   |   |   |   |   |   |   |   |   |   |    |    |    |    |    |    |    |    |    |    |    |    |    |    |    |    |    |    |    |    |    |  |  |  |  |  |  |  |  |   |          |
|   | Trash/Recycling Pick up | Planning & Zoning ABR Meeting - BD |                                      |          |   |          |   |  |   |   |   |   |   |   |   |   |   |    |    |    |    |    |    |    |    |    |    |    |    |    |    |    |    |    |    |    |    |    |    |  |  |  |  |   |   |   |   |   |   |   |   |   |   |   |   |   |   |   |   |    |    |    |    |    |    |    |    |    |    |    |    |    |    |    |    |    |    |    |    |    |  |  |  |  |  |  |  |  |   |          |
| 25  | 26                      | 27                                 | 28                                   | 29       | 30  | 31       |   |  |   |   |   |   |   |   |   |   |   |    |    |    |    |    |    |    |    |    |    |    |    |    |    |    |    |    |    |    |    |    |    |  |  |  |  |   |   |   |   |   |   |   |   |   |   |   |   |   |   |   |   |    |    |    |    |    |    |    |    |    |    |    |    |    |    |    |    |    |    |    |    |    |  |  |  |  |  |  |  |  |   |          |
|   | Trash/Recycling Pick up |                                    |                                      |          |    |          |   |  |   |   |   |   |   |   |   |   |   |    |    |    |    |    |    |    |    |    |    |    |    |    |    |    |    |    |    |    |    |    |    |  |  |  |  |   |   |   |   |   |   |   |   |   |   |   |   |   |   |   |   |    |    |    |    |    |    |    |    |    |    |    |    |    |    |    |    |    |    |    |    |    |  |  |  |  |  |  |  |  |   |          |

## Scrap Tire Collection

Orange Village Service Department will collect scrap tires that are removed from the rim. They may be dropped off at Orange Village Service Department, 4680 Lander Road, September 9 through September 20.

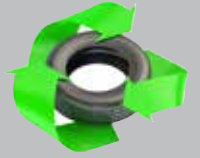

**MYTH: It doesn't matter if something belongs in the recycling cart, the hauler will sort everything anyway.**

**ANSWER: False**

There are increasing amounts of non-recyclable items sent to Material Recovery Facilities, and all of them must be removed by hand by trained staff or mechanically sorted so they don't contaminate the high-value recyclables. Non-recyclable items placed in your recycling containers increase the cost of recycling, slows the process, and pose safety risks to employees. Recycle only cans, cartons, glass, paper, cardboard, plastic bottles and jugs. **When in doubt, throw it out!**

**MYTH: Hoses, tanks, shower curtains, swing sets, etc. are made of plastic, so they must be recyclable.**

**ANSWER: False**

If it's not listed on page 5 (Recycle these in Your Recycle Container), it doesn't belong in your recycling cart and may even require special handling. Just because an item is made from plastic, or contains plastic parts, doesn't mean recycling facilities can handle it.

## Energy Conservation Tips

Source: Cuyahoga County Solid Waste District

- 🌍 Close doors and heating vents in rooms rarely used and lower the thermostat and use a space heater in rooms you use. For every one degree lowered, you'll save up to 5% on your heating bill in the winter.
- 🌍 Unplug chargers such as cell phones and iPods when not in use. Only 5% of the power drawn by a cell phone charger is used to charge the phone. The other 95% is wasted when it is left plugged into the wall.
- 🌍 25-40% of all heating or cooling produced by your furnace or air condition unit is lost through leaky ductwork. Fix the duct work and save an extra \$160 on the annual heating and cooling bill.
- 🌍 Save on gas. For every mile per hour over 55 that is driven, the fuel economy drops 2%.



## DISPOSAL OF VEHICLE BATTERIES

Vehicle batteries contain lead and sulfuric acid, which can pose a serious risk to the environment and your health. A sealed battery is safe to handle, but improperly disposing of a battery is dangerous.

Ohio law prohibits the disposal of lead acid batteries in landfills. The law also requires wholesalers and retailers of lead acid batteries to take your old battery for recycling when you buy a new one. Batteries that are covered by



the law include batteries used in vehicles, motorcycles, wheelchairs, boats or other forms of motive power.

Many local retailers accept and recycle lead acid batteries including Advance Auto Parts, AutoZone and other vehicle repair shops. Scrap metal yards such as Bedford Metal Recycling may also pay you for your old battery. Contact your local auto parts store or scrap metal yard for more information.

Don't miss out -- Important information is sent bi-monthly in our Orange Village e-newsletter. Sign up at [www.OrangeVillage.com](http://www.OrangeVillage.com)

# September 2024

ALL ACTIVITIES ARE LOCATED AT ORANGE VILLAGE HALL  
4600 LANDER ROAD, UNLESS OTHERWISE NOTED  
BD - Building Department and SD - Service Department  
located at 4680 Lander Rd.

| Sunday   | Monday   | Tuesday   | Wednesday  | Thursday  | Friday  | Saturday  |   |   |   |   |   |   |  |  |  |  |   |   |   |   |   |   |   |   |   |    |    |    |    |    |    |    |    |    |    |    |    |    |    |    |    |    |    |    |    |    |    |  |   |   |   |   |   |   |   |  |  |   |   |   |   |   |   |   |   |   |    |    |    |    |    |    |    |    |    |    |    |    |    |    |    |    |    |    |    |    |    |    |  |  |
|--|--|---|--|-----------|---|-----------|---|---|---|---|---|---|--|--|--|--|---|---|---|---|---|---|---|---|---|----|----|----|----|----|----|----|----|----|----|----|----|----|----|----|----|----|----|----|----|----|----|--|---|---|---|---|---|---|---|--|--|---|---|---|---|---|---|---|---|---|----|----|----|----|----|----|----|----|----|----|----|----|----|----|----|----|----|----|----|----|----|----|--|--|
| 1  |  <b>2</b><br><b>Orange Schools Closed</b><br><b>Village Hall Closed</b><br><b>No Trash/Recycling Pick up</b>            | <b>3</b><br>Planning & Zoning<br>ABR Meeting - BD<br><b>Trash/Recycling Pick up</b> | <b>4</b><br>Council Work<br>Session/Special<br>Meeting   | <b>5</b>  |  <b>6</b><br>Computer, Flags &<br>Household Hazardous<br>Waste Collection<br>7 a.m. - 3 p.m. - SD  | <b>7</b>  |   |   |   |   |   |   |  |  |  |  |   |   |   |   |   |   |   |   |   |    |    |    |    |    |    |    |    |    |    |    |    |    |    |    |    |    |    |    |    |    |    |  |   |   |   |   |   |   |   |  |  |   |   |   |   |   |   |   |   |   |    |    |    |    |    |    |    |    |    |    |    |    |    |    |    |    |    |    |    |    |    |    |  |  |
| 8  |  <b>9</b><br><b>Scrap Tire Collection Begins - SD</b><br><b>7:00 a.m. - 3:00 p.m.</b><br><b>Trash/Recycling Pick up</b> | <b>10</b>   |  <b>11</b><br>Finance Meeting<br>Council Meeting | <b>12</b> | <b>13</b>   | <b>14</b> |   |   |   |   |   |   |  |  |  |  |   |   |   |   |   |   |   |   |   |    |    |    |    |    |    |    |    |    |    |    |    |    |    |    |    |    |    |    |    |    |    |  |   |   |   |   |   |   |   |  |  |   |   |   |   |   |   |   |   |   |    |    |    |    |    |    |    |    |    |    |    |    |    |    |    |    |    |    |    |    |    |    |  |  |
| 15   | <b>16</b><br><b>Branch Chipping</b><br><b>Trash/Recycling Pick up</b>  | <b>17</b><br>Planning & Zoning<br>ABR Meeting - BD                                  | <b>18</b>  | <b>19</b> |  <b>20</b><br><b>Scrap Tire Collection Ends - SD</b><br><b>7:00 a.m. - 3:00 p.m.</b>   | <b>21</b> |   |   |   |   |   |   |  |  |  |  |   |   |   |   |   |   |   |   |   |    |    |    |    |    |    |    |    |    |    |    |    |    |    |    |    |    |    |    |    |    |    |  |   |   |   |   |   |   |   |  |  |   |   |   |   |   |   |   |   |   |    |    |    |    |    |    |    |    |    |    |    |    |    |    |    |    |    |    |    |    |    |    |  |  |
|  <b>22</b> | <b>23</b><br><b>Trash/Recycling Pick up</b>  | <b>24</b>   | <b>25</b>  | <b>26</b> | <b>27</b>   | <b>28</b> |   |   |   |   |   |   |  |  |  |  |   |   |   |   |   |   |   |   |   |    |    |    |    |    |    |    |    |    |    |    |    |    |    |    |    |    |    |    |    |    |    |  |   |   |   |   |   |   |   |  |  |   |   |   |   |   |   |   |   |   |    |    |    |    |    |    |    |    |    |    |    |    |    |    |    |    |    |    |    |    |    |    |  |  |
| <b>29</b>  | <b>30</b><br><b>Trash/Recycling Pick up</b>  |   |  |           | August 2024<br><table> <tr><th>S</th><th>M</th><th>T</th><th>W</th><th>T</th><th>F</th><th>S</th></tr> <tr><td></td><td></td><td></td><td></td><td>1</td><td>2</td><td>3</td></tr> <tr><td>4</td><td>5</td><td>6</td><td>7</td><td>8</td><td>9</td><td>10</td></tr> <tr><td>11</td><td>12</td><td>13</td><td>14</td><td>15</td><td>16</td><td>17</td></tr> <tr><td>18</td><td>19</td><td>20</td><td>21</td><td>22</td><td>23</td><td>24</td></tr> <tr><td>25</td><td>26</td><td>27</td><td>28</td><td>29</td><td>30</td><td>31</td></tr> </table> | S         | M | T | W | T | F | S |  |  |  |  | 1 | 2 | 3 | 4 | 5 | 6 | 7 | 8 | 9 | 10 | 11 | 12 | 13 | 14 | 15 | 16 | 17 | 18 | 19 | 20 | 21 | 22 | 23 | 24 | 25 | 26 | 27 | 28 | 29 | 30 | 31 | October 2024<br><table> <tr><th>S</th><th>M</th><th>T</th><th>W</th><th>T</th><th>F</th><th>S</th></tr> <tr><td></td><td></td><td>1</td><td>2</td><td>3</td><td>4</td><td>5</td></tr> <tr><td>6</td><td>7</td><td>8</td><td>9</td><td>10</td><td>11</td><td>12</td></tr> <tr><td>13</td><td>14</td><td>15</td><td>16</td><td>17</td><td>18</td><td>19</td></tr> <tr><td>20</td><td>21</td><td>22</td><td>23</td><td>24</td><td>25</td><td>26</td></tr> <tr><td>27</td><td>28</td><td>29</td><td>30</td><td>31</td><td></td><td></td></tr> </table> | S | M | T | W | T | F | S |  |  | 1 | 2 | 3 | 4 | 5 | 6 | 7 | 8 | 9 | 10 | 11 | 12 | 13 | 14 | 15 | 16 | 17 | 18 | 19 | 20 | 21 | 22 | 23 | 24 | 25 | 26 | 27 | 28 | 29 | 30 | 31 |  |  |
| S  | M  | T   | W  | T         | F   | S         |   |   |   |   |   |   |  |  |  |  |   |   |   |   |   |   |   |   |   |    |    |    |    |    |    |    |    |    |    |    |    |    |    |    |    |    |    |    |    |    |    |  |   |   |   |   |   |   |   |  |  |   |   |   |   |   |   |   |   |   |    |    |    |    |    |    |    |    |    |    |    |    |    |    |    |    |    |    |    |    |    |    |  |  |
|  |  |   |  | 1         | 2   | 3         |   |   |   |   |   |   |  |  |  |  |   |   |   |   |   |   |   |   |   |    |    |    |    |    |    |    |    |    |    |    |    |    |    |    |    |    |    |    |    |    |    |  |   |   |   |   |   |   |   |  |  |   |   |   |   |   |   |   |   |   |    |    |    |    |    |    |    |    |    |    |    |    |    |    |    |    |    |    |    |    |    |    |  |  |
| 4  | 5  | 6   | 7  | 8         | 9   | 10        |   |   |   |   |   |   |  |  |  |  |   |   |   |   |   |   |   |   |   |    |    |    |    |    |    |    |    |    |    |    |    |    |    |    |    |    |    |    |    |    |    |  |   |   |   |   |   |   |   |  |  |   |   |   |   |   |   |   |   |   |    |    |    |    |    |    |    |    |    |    |    |    |    |    |    |    |    |    |    |    |    |    |  |  |
| 11   | 12   | 13  | 14   | 15        | 16  | 17        |   |   |   |   |   |   |  |  |  |  |   |   |   |   |   |   |   |   |   |    |    |    |    |    |    |    |    |    |    |    |    |    |    |    |    |    |    |    |    |    |    |  |   |   |   |   |   |   |   |  |  |   |   |   |   |   |   |   |   |   |    |    |    |    |    |    |    |    |    |    |    |    |    |    |    |    |    |    |    |    |    |    |  |  |
| 18   | 19   | 20  | 21   | 22        | 23  | 24        |   |   |   |   |   |   |  |  |  |  |   |   |   |   |   |   |   |   |   |    |    |    |    |    |    |    |    |    |    |    |    |    |    |    |    |    |    |    |    |    |    |  |   |   |   |   |   |   |   |  |  |   |   |   |   |   |   |   |   |   |    |    |    |    |    |    |    |    |    |    |    |    |    |    |    |    |    |    |    |    |    |    |  |  |
| 25   | 26   | 27  | 28   | 29        | 30  | 31        |   |   |   |   |   |   |  |  |  |  |   |   |   |   |   |   |   |   |   |    |    |    |    |    |    |    |    |    |    |    |    |    |    |    |    |    |    |    |    |    |    |  |   |   |   |   |   |   |   |  |  |   |   |   |   |   |   |   |   |   |    |    |    |    |    |    |    |    |    |    |    |    |    |    |    |    |    |    |    |    |    |    |  |  |
| S  | M  | T   | W  | T         | F   | S         |   |   |   |   |   |   |  |  |  |  |   |   |   |   |   |   |   |   |   |    |    |    |    |    |    |    |    |    |    |    |    |    |    |    |    |    |    |    |    |    |    |  |   |   |   |   |   |   |   |  |  |   |   |   |   |   |   |   |   |   |    |    |    |    |    |    |    |    |    |    |    |    |    |    |    |    |    |    |    |    |    |    |  |  |
|  |  | 1   | 2  | 3         | 4   | 5         |   |   |   |   |   |   |  |  |  |  |   |   |   |   |   |   |   |   |   |    |    |    |    |    |    |    |    |    |    |    |    |    |    |    |    |    |    |    |    |    |    |  |   |   |   |   |   |   |   |  |  |   |   |   |   |   |   |   |   |   |    |    |    |    |    |    |    |    |    |    |    |    |    |    |    |    |    |    |    |    |    |    |  |  |
| 6  | 7  | 8   | 9  | 10        | 11  | 12        |   |   |   |   |   |   |  |  |  |  |   |   |   |   |   |   |   |   |   |    |    |    |    |    |    |    |    |    |    |    |    |    |    |    |    |    |    |    |    |    |    |  |   |   |   |   |   |   |   |  |  |   |   |   |   |   |   |   |   |   |    |    |    |    |    |    |    |    |    |    |    |    |    |    |    |    |    |    |    |    |    |    |  |  |
| 13   | 14   | 15  | 16   | 17        | 18  | 19        |   |   |   |   |   |   |  |  |  |  |   |   |   |   |   |   |   |   |   |    |    |    |    |    |    |    |    |    |    |    |    |    |    |    |    |    |    |    |    |    |    |  |   |   |   |   |   |   |   |  |  |   |   |   |   |   |   |   |   |   |    |    |    |    |    |    |    |    |    |    |    |    |    |    |    |    |    |    |    |    |    |    |  |  |
| 20   | 21   | 22  | 23   | 24        | 25  | 26        |   |   |   |   |   |   |  |  |  |  |   |   |   |   |   |   |   |   |   |    |    |    |    |    |    |    |    |    |    |    |    |    |    |    |    |    |    |    |    |    |    |  |   |   |   |   |   |   |   |  |  |   |   |   |   |   |   |   |   |   |    |    |    |    |    |    |    |    |    |    |    |    |    |    |    |    |    |    |    |    |    |    |  |  |
| 27   | 28   | 29  | 30   | 31        |   |           |   |   |   |   |   |   |  |  |  |  |   |   |   |   |   |   |   |   |   |    |    |    |    |    |    |    |    |    |    |    |    |    |    |    |    |    |    |    |    |    |    |  |   |   |   |   |   |   |   |  |  |   |   |   |   |   |   |   |   |   |    |    |    |    |    |    |    |    |    |    |    |    |    |    |    |    |    |    |    |    |    |    |  |  |

## **Leaf Collection**

**Begins Monday, October 21**  
**Ends Wednesday, November 27**

Orange Village Service Department collects leaves and turns them into a rich compost that can be added to gardens and soil. This compost will be delivered to residents who request loads. Please see March for more information on ordering leaf humus.

### **How To Place Leaves for Pickup**

- Leaves should be placed close to the edge of the road.
  - They should not extend into the road.
- Leaves should be in a long row no farther off the road than 8 feet.
- Do not mix branches or foreign objects with the leaves. This can cause damage to the machine.



## **How Long Does It Last in the Landfill?**



Glass Bottles  
Forever



Styrofoam  
Forever



Plastic Grocery  
Bags  
Up to 1,000  
years



Aluminum Cans  
500 years



Disposable Diaper  
Estimated 250 -  
500 years



Plastic Jug  
450 years



Steel Can  
80 - 100 years



Cigarette Butt  
2 - 5 years



Wood  
At least 4 years



Newspaper  
2 - 5 weeks



Banana Peel  
2 - 5 weeks



Apple core  
2 months

# October 2024

ALL ACTIVITIES ARE LOCATED AT ORANGE VILLAGE HALL  
4600 LANDER ROAD, UNLESS OTHERWISE NOTED  
BD - Building Department and SD - Service Department  
located at 4680 Lander Rd.

| Sunday | Monday  | Tuesday   | Wednesday  | Thursday   | Friday  | Saturday  |   |   |   |   |   |   |   |   |   |   |   |   |   |   |   |    |    |    |    |    |    |    |    |    |    |    |    |    |    |    |    |    |    |    |    |    |  |  |  |  |  |  |   |   |   |   |   |   |   |  |  |  |  |  |   |   |   |   |   |   |   |   |   |    |    |    |    |    |    |    |    |    |    |    |    |    |    |    |    |    |    |    |    |    |
|--------|---|---|--|--|---|---|---|---|---|---|---|---|---|---|---|---|---|---|---|---|---|----|----|----|----|----|----|----|----|----|----|----|----|----|----|----|----|----|----|----|----|----|--|--|--|--|--|--|---|---|---|---|---|---|---|--|--|--|--|--|---|---|---|---|---|---|---|---|---|----|----|----|----|----|----|----|----|----|----|----|----|----|----|----|----|----|----|----|----|----|
|        |   | 1<br><br>Planning & Zoning<br>ABR Meeting - BD  | 2<br><br>Council Work<br>Session/Special<br>Meeting<br>CANCELLED<br>Rosh Hashanah<br>begins at Sundown | 3<br><br><br>Rosh Hashanah                        | 4<br><br><br>Computer, Flags &<br>Household Hazardous<br>Waste Collection<br>7 a.m. - 3 p.m. - SD  | 5   |   |   |   |   |   |   |   |   |   |   |   |   |   |   |   |    |    |    |    |    |    |    |    |    |    |    |    |    |    |    |    |    |    |    |    |    |  |  |  |  |  |  |   |   |   |   |   |   |   |  |  |  |  |  |   |   |   |   |   |   |   |   |   |    |    |    |    |    |    |    |    |    |    |    |    |    |    |    |    |    |    |    |    |    |
| 6      | 7<br><br>Trash/Recycling<br>Pick up   | 8   | 9<br><br>Finance Meeting<br>Council Meeting  | 10   | 11<br><br>Yom Kippur begins<br>at sundown   | 12<br><br> |   |   |   |   |   |   |   |   |   |   |   |   |   |   |   |    |    |    |    |    |    |    |    |    |    |    |    |    |    |    |    |    |    |    |    |    |  |  |  |  |  |  |   |   |   |   |   |   |   |  |  |  |  |  |   |   |   |   |   |   |   |   |   |    |    |    |    |    |    |    |    |    |    |    |    |    |    |    |    |    |    |    |    |    |
| 13     | 14<br><br><br>Columbus day<br>Trash/Recycling<br>Pick up             | 15<br><br>Planning & Zoning<br>ABR Meeting - BD | 16   | 17   | 18<br><br><br>Paper Shredding<br>Orange Village SD<br>4680 Lander Rd<br>9:00 a.m. - noon   | 19<br><br>HAPPY<br>Sweetest<br>DAY  |   |   |   |   |   |   |   |   |   |   |   |   |   |   |   |    |    |    |    |    |    |    |    |    |    |    |    |    |    |    |    |    |    |    |    |    |  |  |  |  |  |  |   |   |   |   |   |   |   |  |  |  |  |  |   |   |   |   |   |   |   |   |   |    |    |    |    |    |    |    |    |    |    |    |    |    |    |    |    |    |    |    |    |    |
| 20     | 21<br><br><br>Leaf Collection Begins<br>Trash/Recycling<br>Pick up | 22  | 23   | 24   | 25  | 26  |   |   |   |   |   |   |   |   |   |   |   |   |   |   |   |    |    |    |    |    |    |    |    |    |    |    |    |    |    |    |    |    |    |    |    |    |  |  |  |  |  |  |   |   |   |   |   |   |   |  |  |  |  |  |   |   |   |   |   |   |   |   |   |    |    |    |    |    |    |    |    |    |    |    |    |    |    |    |    |    |    |    |    |    |
| 27     | 28<br><br>Trash/Recycling<br>Pick up  | 29  | 30   | 31<br><br><br>Trick or Treat<br>6 p.m. - 8 p.m. | September 2024 <table> <tr><th>S</th><th>M</th><th>T</th><th>W</th><th>T</th><th>F</th><th>S</th></tr> <tr><td>1</td><td>2</td><td>3</td><td>4</td><td>5</td><td>6</td><td>7</td></tr> <tr><td>8</td><td>9</td><td>10</td><td>11</td><td>12</td><td>13</td><td>14</td></tr> <tr><td>15</td><td>16</td><td>17</td><td>18</td><td>19</td><td>20</td><td>21</td></tr> <tr><td>22</td><td>23</td><td>24</td><td>25</td><td>26</td><td>27</td><td>28</td></tr> <tr><td>29</td><td>30</td><td></td><td></td><td></td><td></td><td></td></tr> </table> | S   | M | T | W | T | F | S | 1 | 2 | 3 | 4 | 5 | 6 | 7 | 8 | 9 | 10 | 11 | 12 | 13 | 14 | 15 | 16 | 17 | 18 | 19 | 20 | 21 | 22 | 23 | 24 | 25 | 26 | 27 | 28 | 29 | 30 |  |  |  |  |  | November 2024 <table> <tr><th>S</th><th>M</th><th>T</th><th>W</th><th>T</th><th>F</th><th>S</th></tr> <tr><td></td><td></td><td></td><td></td><td></td><td>1</td><td>2</td></tr> <tr><td>3</td><td>4</td><td>5</td><td>6</td><td>7</td><td>8</td><td>9</td></tr> <tr><td>10</td><td>11</td><td>12</td><td>13</td><td>14</td><td>15</td><td>16</td></tr> <tr><td>17</td><td>18</td><td>19</td><td>20</td><td>21</td><td>22</td><td>23</td></tr> <tr><td>24</td><td>25</td><td>26</td><td>27</td><td>28</td><td>29</td><td>30</td></tr> </table> | S | M | T | W | T | F | S |  |  |  |  |  | 1 | 2 | 3 | 4 | 5 | 6 | 7 | 8 | 9 | 10 | 11 | 12 | 13 | 14 | 15 | 16 | 17 | 18 | 19 | 20 | 21 | 22 | 23 | 24 | 25 | 26 | 27 | 28 | 29 | 30 |
| S      | M   | T   | W  | T  | F   | S   |   |   |   |   |   |   |   |   |   |   |   |   |   |   |   |    |    |    |    |    |    |    |    |    |    |    |    |    |    |    |    |    |    |    |    |    |  |  |  |  |  |  |   |   |   |   |   |   |   |  |  |  |  |  |   |   |   |   |   |   |   |   |   |    |    |    |    |    |    |    |    |    |    |    |    |    |    |    |    |    |    |    |    |    |
| 1      | 2   | 3   | 4  | 5  | 6   | 7   |   |   |   |   |   |   |   |   |   |   |   |   |   |   |   |    |    |    |    |    |    |    |    |    |    |    |    |    |    |    |    |    |    |    |    |    |  |  |  |  |  |  |   |   |   |   |   |   |   |  |  |  |  |  |   |   |   |   |   |   |   |   |   |    |    |    |    |    |    |    |    |    |    |    |    |    |    |    |    |    |    |    |    |    |
| 8      | 9   | 10  | 11   | 12   | 13  | 14  |   |   |   |   |   |   |   |   |   |   |   |   |   |   |   |    |    |    |    |    |    |    |    |    |    |    |    |    |    |    |    |    |    |    |    |    |  |  |  |  |  |  |   |   |   |   |   |   |   |  |  |  |  |  |   |   |   |   |   |   |   |   |   |    |    |    |    |    |    |    |    |    |    |    |    |    |    |    |    |    |    |    |    |    |
| 15     | 16  | 17  | 18   | 19   | 20  | 21  |   |   |   |   |   |   |   |   |   |   |   |   |   |   |   |    |    |    |    |    |    |    |    |    |    |    |    |    |    |    |    |    |    |    |    |    |  |  |  |  |  |  |   |   |   |   |   |   |   |  |  |  |  |  |   |   |   |   |   |   |   |   |   |    |    |    |    |    |    |    |    |    |    |    |    |    |    |    |    |    |    |    |    |    |
| 22     | 23  | 24  | 25   | 26   | 27  | 28  |   |   |   |   |   |   |   |   |   |   |   |   |   |   |   |    |    |    |    |    |    |    |    |    |    |    |    |    |    |    |    |    |    |    |    |    |  |  |  |  |  |  |   |   |   |   |   |   |   |  |  |  |  |  |   |   |   |   |   |   |   |   |   |    |    |    |    |    |    |    |    |    |    |    |    |    |    |    |    |    |    |    |    |    |
| 29     | 30  |   |  |  |   |   |   |   |   |   |   |   |   |   |   |   |   |   |   |   |   |    |    |    |    |    |    |    |    |    |    |    |    |    |    |    |    |    |    |    |    |    |  |  |  |  |  |  |   |   |   |   |   |   |   |  |  |  |  |  |   |   |   |   |   |   |   |   |   |    |    |    |    |    |    |    |    |    |    |    |    |    |    |    |    |    |    |    |    |    |
| S      | M   | T   | W  | T  | F   | S   |   |   |   |   |   |   |   |   |   |   |   |   |   |   |   |    |    |    |    |    |    |    |    |    |    |    |    |    |    |    |    |    |    |    |    |    |  |  |  |  |  |  |   |   |   |   |   |   |   |  |  |  |  |  |   |   |   |   |   |   |   |   |   |    |    |    |    |    |    |    |    |    |    |    |    |    |    |    |    |    |    |    |    |    |
|        |   |   |  |  | 1   | 2   |   |   |   |   |   |   |   |   |   |   |   |   |   |   |   |    |    |    |    |    |    |    |    |    |    |    |    |    |    |    |    |    |    |    |    |    |  |  |  |  |  |  |   |   |   |   |   |   |   |  |  |  |  |  |   |   |   |   |   |   |   |   |   |    |    |    |    |    |    |    |    |    |    |    |    |    |    |    |    |    |    |    |    |    |
| 3      | 4   | 5   | 6  | 7  | 8   | 9   |   |   |   |   |   |   |   |   |   |   |   |   |   |   |   |    |    |    |    |    |    |    |    |    |    |    |    |    |    |    |    |    |    |    |    |    |  |  |  |  |  |  |   |   |   |   |   |   |   |  |  |  |  |  |   |   |   |   |   |   |   |   |   |    |    |    |    |    |    |    |    |    |    |    |    |    |    |    |    |    |    |    |    |    |
| 10     | 11  | 12  | 13   | 14   | 15  | 16  |   |   |   |   |   |   |   |   |   |   |   |   |   |   |   |    |    |    |    |    |    |    |    |    |    |    |    |    |    |    |    |    |    |    |    |    |  |  |  |  |  |  |   |   |   |   |   |   |   |  |  |  |  |  |   |   |   |   |   |   |   |   |   |    |    |    |    |    |    |    |    |    |    |    |    |    |    |    |    |    |    |    |    |    |
| 17     | 18  | 19  | 20   | 21   | 22  | 23  |   |   |   |   |   |   |   |   |   |   |   |   |   |   |   |    |    |    |    |    |    |    |    |    |    |    |    |    |    |    |    |    |    |    |    |    |  |  |  |  |  |  |   |   |   |   |   |   |   |  |  |  |  |  |   |   |   |   |   |   |   |   |   |    |    |    |    |    |    |    |    |    |    |    |    |    |    |    |    |    |    |    |    |    |
| 24     | 25  | 26  | 27   | 28   | 29  | 30  |   |   |   |   |   |   |   |   |   |   |   |   |   |   |   |    |    |    |    |    |    |    |    |    |    |    |    |    |    |    |    |    |    |    |    |    |  |  |  |  |  |  |   |   |   |   |   |   |   |  |  |  |  |  |   |   |   |   |   |   |   |   |   |    |    |    |    |    |    |    |    |    |    |    |    |    |    |    |    |    |    |    |    |    |

## The Fire Department Responds to the Holidays!

### Delivery Date: Saturday, December 21

*Gifts will be accepted beginning Monday, November 25 at 8:30 a.m.  
Last day for drop off is Thursday, December 12 at 4:00 p.m.*



The members of your Orange Village Fire Department are proud to once again offer this wonderful and unique holiday experience. We will begin accepting gifts on Monday, November 25 at 8:30 a.m. at Orange Village Hall, 4600 Lander Road. Please get your gifts in early, this is a very popular event and there are a limited number of stops. Santa will arrive on the fire truck for delivery of Christmas presents. The Fire Department will also offer a delivery of Hanukkah presents. The forms will be available on our website at [www.orangevillage.com](http://www.orangevillage.com) and our Facebook pages. **Gifts must be shoe box size or smaller.**

All deliveries will begin at 1:00 p.m. on Saturday, December 21. If the event has not reached capacity, the last day to drop off your gifts to Village Hall is Thursday, December 12 at 4:00 p.m. For more details contact Assistant Chief Larry Genova at 440-498-4402.



### ***Elect to Recycle***



Orange Village will be collecting campaign signs throughout the Village the day after elections for recycling. If you would like to keep your campaign signs please contact the Service Department at 440-498-4403 prior to election day. All political yard signs will be taken to the Cuyahoga County Solid Waste District to be recycled.

**By recycling your campaign signs,  
you're casting a vote for the environment.  
When we recycle, everybody wins!**

### **Fryer Oil - Don't Dump It!**

Over 2 million people across the country deep-fry their turkey every Thanksgiving, and cleaning up can be troublesome. With 3-to-5 gallons of used oil on your hands, disposing of it isn't as easy as just throwing it in the garbage. Please, **DO NOT** pour it down the drain either!

Fryer oil from a home can be properly recycled through our Household Hazardous Waste Program, the first Friday of every month from 7 a.m. to 3 p.m. at the Service Department, 4680 Lander Road.



# November 2024

ALL ACTIVITIES ARE LOCATED AT ORANGE VILLAGE HALL  
4600 LANDER ROAD, UNLESS OTHERWISE NOTED  
BD - Building Department and SD - Service Department  
located at 4680 Lander Rd.

| Sunday   | Monday   | Tuesday   | Wednesday   | Thursday  | Friday           | Saturday         |   |  |  |   |   |   |   |   |   |   |   |   |    |    |    |    |    |    |    |    |    |    |    |    |    |    |    |    |    |    |    |    |    |    |  |  |   |   |   |   |   |   |   |   |   |   |   |   |   |   |   |   |   |    |    |    |    |    |    |    |    |    |    |    |    |    |    |    |    |    |    |    |    |    |    |  |  |  |  |  |  |  |  |                 |
|--|--|---|---|---|------------------|------------------|---|--|--|---|---|---|---|---|---|---|---|---|----|----|----|----|----|----|----|----|----|----|----|----|----|----|----|----|----|----|----|----|----|----|--|--|---|---|---|---|---|---|---|---|---|---|---|---|---|---|---|---|---|----|----|----|----|----|----|----|----|----|----|----|----|----|----|----|----|----|----|----|----|----|----|--|--|--|--|--|--|--|--|-----------------|
| <p>October 2024</p> <table> <tr><td>S</td><td>M</td><td>T</td><td>W</td><td>T</td><td>F</td><td>S</td></tr> <tr><td></td><td></td><td>1</td><td>2</td><td>3</td><td>4</td><td>5</td></tr> <tr><td>6</td><td>7</td><td>8</td><td>9</td><td>10</td><td>11</td><td>12</td></tr> <tr><td>13</td><td>14</td><td>15</td><td>16</td><td>17</td><td>18</td><td>19</td></tr> <tr><td>20</td><td>21</td><td>22</td><td>23</td><td>24</td><td>25</td><td>26</td></tr> <tr><td>27</td><td>28</td><td>29</td><td>30</td><td>31</td><td></td><td></td></tr> </table> | S  | M   | T   | W   | T                | F                | S |  |  | 1 | 2 | 3 | 4 | 5 | 6 | 7 | 8 | 9 | 10 | 11 | 12 | 13 | 14 | 15 | 16 | 17 | 18 | 19 | 20 | 21 | 22 | 23 | 24 | 25 | 26 | 27 | 28 | 29 | 30 | 31 |  |  | <p>December 2024</p> <table> <tr><td>S</td><td>M</td><td>T</td><td>W</td><td>T</td><td>F</td><td>S</td></tr> <tr><td>1</td><td>2</td><td>3</td><td>4</td><td>5</td><td>6</td><td>7</td></tr> <tr><td>8</td><td>9</td><td>10</td><td>11</td><td>12</td><td>13</td><td>14</td></tr> <tr><td>15</td><td>16</td><td>17</td><td>18</td><td>19</td><td>20</td><td>21</td></tr> <tr><td>22</td><td>23</td><td>24</td><td>25</td><td>26</td><td>27</td><td>28</td></tr> <tr><td>29</td><td>30</td><td>31</td><td></td><td></td><td></td><td></td></tr> </table> | S | M | T | W | T | F | S | 1 | 2 | 3 | 4 | 5 | 6 | 7 | 8 | 9 | 10 | 11 | 12 | 13 | 14 | 15 | 16 | 17 | 18 | 19 | 20 | 21 | 22 | 23 | 24 | 25 | 26 | 27 | 28 | 29 | 30 | 31 |  |  |  |  |  |  |  |  <p><b>1</b></p> <p>Computer, Flags &amp;<br/>Household Hazardous<br/>Waste Collection<br/>7 a.m. - 3 p.m. - SD</p> | <p><b>2</b></p> |
| S  | M  | T   | W   | T   | F                | S                |   |  |  |   |   |   |   |   |   |   |   |   |    |    |    |    |    |    |    |    |    |    |    |    |    |    |    |    |    |    |    |    |    |    |  |  |   |   |   |   |   |   |   |   |   |   |   |   |   |   |   |   |   |    |    |    |    |    |    |    |    |    |    |    |    |    |    |    |    |    |    |    |    |    |    |  |  |  |  |  |  |  |  |                 |
|  |  | 1   | 2   | 3   | 4                | 5                |   |  |  |   |   |   |   |   |   |   |   |   |    |    |    |    |    |    |    |    |    |    |    |    |    |    |    |    |    |    |    |    |    |    |  |  |   |   |   |   |   |   |   |   |   |   |   |   |   |   |   |   |   |    |    |    |    |    |    |    |    |    |    |    |    |    |    |    |    |    |    |    |    |    |    |  |  |  |  |  |  |  |  |                 |
| 6  | 7  | 8   | 9   | 10  | 11               | 12               |   |  |  |   |   |   |   |   |   |   |   |   |    |    |    |    |    |    |    |    |    |    |    |    |    |    |    |    |    |    |    |    |    |    |  |  |   |   |   |   |   |   |   |   |   |   |   |   |   |   |   |   |   |    |    |    |    |    |    |    |    |    |    |    |    |    |    |    |    |    |    |    |    |    |    |  |  |  |  |  |  |  |  |                 |
| 13   | 14   | 15  | 16  | 17  | 18               | 19               |   |  |  |   |   |   |   |   |   |   |   |   |    |    |    |    |    |    |    |    |    |    |    |    |    |    |    |    |    |    |    |    |    |    |  |  |   |   |   |   |   |   |   |   |   |   |   |   |   |   |   |   |   |    |    |    |    |    |    |    |    |    |    |    |    |    |    |    |    |    |    |    |    |    |    |  |  |  |  |  |  |  |  |                 |
| 20   | 21   | 22  | 23  | 24  | 25               | 26               |   |  |  |   |   |   |   |   |   |   |   |   |    |    |    |    |    |    |    |    |    |    |    |    |    |    |    |    |    |    |    |    |    |    |  |  |   |   |   |   |   |   |   |   |   |   |   |   |   |   |   |   |   |    |    |    |    |    |    |    |    |    |    |    |    |    |    |    |    |    |    |    |    |    |    |  |  |  |  |  |  |  |  |                 |
| 27   | 28   | 29  | 30  | 31  |                  |                  |   |  |  |   |   |   |   |   |   |   |   |   |    |    |    |    |    |    |    |    |    |    |    |    |    |    |    |    |    |    |    |    |    |    |  |  |   |   |   |   |   |   |   |   |   |   |   |   |   |   |   |   |   |    |    |    |    |    |    |    |    |    |    |    |    |    |    |    |    |    |    |    |    |    |    |  |  |  |  |  |  |  |  |                 |
| S  | M  | T   | W   | T   | F                | S                |   |  |  |   |   |   |   |   |   |   |   |   |    |    |    |    |    |    |    |    |    |    |    |    |    |    |    |    |    |    |    |    |    |    |  |  |   |   |   |   |   |   |   |   |   |   |   |   |   |   |   |   |   |    |    |    |    |    |    |    |    |    |    |    |    |    |    |    |    |    |    |    |    |    |    |  |  |  |  |  |  |  |  |                 |
| 1  | 2  | 3   | 4   | 5   | 6                | 7                |   |  |  |   |   |   |   |   |   |   |   |   |    |    |    |    |    |    |    |    |    |    |    |    |    |    |    |    |    |    |    |    |    |    |  |  |   |   |   |   |   |   |   |   |   |   |   |   |   |   |   |   |   |    |    |    |    |    |    |    |    |    |    |    |    |    |    |    |    |    |    |    |    |    |    |  |  |  |  |  |  |  |  |                 |
| 8  | 9  | 10  | 11  | 12  | 13               | 14               |   |  |  |   |   |   |   |   |   |   |   |   |    |    |    |    |    |    |    |    |    |    |    |    |    |    |    |    |    |    |    |    |    |    |  |  |   |   |   |   |   |   |   |   |   |   |   |   |   |   |   |   |   |    |    |    |    |    |    |    |    |    |    |    |    |    |    |    |    |    |    |    |    |    |    |  |  |  |  |  |  |  |  |                 |
| 15   | 16   | 17  | 18  | 19  | 20               | 21               |   |  |  |   |   |   |   |   |   |   |   |   |    |    |    |    |    |    |    |    |    |    |    |    |    |    |    |    |    |    |    |    |    |    |  |  |   |   |   |   |   |   |   |   |   |   |   |   |   |   |   |   |   |    |    |    |    |    |    |    |    |    |    |    |    |    |    |    |    |    |    |    |    |    |    |  |  |  |  |  |  |  |  |                 |
| 22   | 23   | 24  | 25  | 26  | 27               | 28               |   |  |  |   |   |   |   |   |   |   |   |   |    |    |    |    |    |    |    |    |    |    |    |    |    |    |    |    |    |    |    |    |    |    |  |  |   |   |   |   |   |   |   |   |   |   |   |   |   |   |   |   |   |    |    |    |    |    |    |    |    |    |    |    |    |    |    |    |    |    |    |    |    |    |    |  |  |  |  |  |  |  |  |                 |
| 29   | 30   | 31  |   |   |                  |                  |   |  |  |   |   |   |   |   |   |   |   |   |    |    |    |    |    |    |    |    |    |    |    |    |    |    |    |    |    |    |    |    |    |    |  |  |   |   |   |   |   |   |   |   |   |   |   |   |   |   |   |   |   |    |    |    |    |    |    |    |    |    |    |    |    |    |    |    |    |    |    |    |    |    |    |  |  |  |  |  |  |  |  |                 |
|  <p><b>3</b></p> <p>Daylight Savings<br/>Time Ends</p>   | <p><b>4</b></p> <p>Trash/Recycling<br/>Pick up</p>   |  <p><b>5</b></p> <p>Planning &amp; Zoning<br/>ABR Meeting - BD</p> | <p><b>6</b></p> <p>Council Work<br/>Session/Special<br/>Meeting</p>   | <p><b>7</b></p>   | <p><b>8</b></p>  | <p><b>9</b></p>  |   |  |  |   |   |   |   |   |   |   |   |   |    |    |    |    |    |    |    |    |    |    |    |    |    |    |    |    |    |    |    |    |    |    |  |  |   |   |   |   |   |   |   |   |   |   |   |   |   |   |   |   |   |    |    |    |    |    |    |    |    |    |    |    |    |    |    |    |    |    |    |    |    |    |    |  |  |  |  |  |  |  |  |                 |
| <p><b>10</b></p>   |  <p><b>11</b></p> <p>Trash/Recycling<br/>Pick up</p>                                | <p><b>12</b></p>  | <p><b>13</b></p> <p>Finance Meeting<br/>Council Meeting</p>   | <p><b>14</b></p>  | <p><b>15</b></p> | <p><b>16</b></p> |   |  |  |   |   |   |   |   |   |   |   |   |    |    |    |    |    |    |    |    |    |    |    |    |    |    |    |    |    |    |    |    |    |    |  |  |   |   |   |   |   |   |   |   |   |   |   |   |   |   |   |   |   |    |    |    |    |    |    |    |    |    |    |    |    |    |    |    |    |    |    |    |    |    |    |  |  |  |  |  |  |  |  |                 |
| <p><b>17</b></p>   | <p><b>18</b></p> <p>Trash/Recycling<br/>Pick up</p>  | <p><b>19</b></p> <p>Planning &amp; Zoning<br/>ABR Meeting - BD</p>  | <p><b>20</b></p>  | <p><b>21</b></p>  | <p><b>22</b></p> | <p><b>23</b></p> |   |  |  |   |   |   |   |   |   |   |   |   |    |    |    |    |    |    |    |    |    |    |    |    |    |    |    |    |    |    |    |    |    |    |  |  |   |   |   |   |   |   |   |   |   |   |   |   |   |   |   |   |   |    |    |    |    |    |    |    |    |    |    |    |    |    |    |    |    |    |    |    |    |    |    |  |  |  |  |  |  |  |  |                 |
| <p><b>24</b></p>   | <p><b>25</b></p> <p><b>First Day<br/>to Drop Off<br/>Gifts for the Fire<br/>Department's<br/>Holiday Delivery<br/>Service</b></p> <p>Trash/Recycling<br/>Pick up</p> | <p><b>26</b></p>  |  <p><b>27</b></p> <p>Leaf Collection<br/>Ends</p> |  <p><b>28</b></p> <p><b>Orange Schools Closed</b></p> <p>Village Hall<br/>Closed</p> | <p><b>29</b></p> | <p><b>30</b></p> |   |  |  |   |   |   |   |   |   |   |   |   |    |    |    |    |    |    |    |    |    |    |    |    |    |    |    |    |    |    |    |    |    |    |  |  |   |   |   |   |   |   |   |   |   |   |   |   |   |   |   |   |   |    |    |    |    |    |    |    |    |    |    |    |    |    |    |    |    |    |    |    |    |    |    |  |  |  |  |  |  |  |  |                 |

# Season's Greetings

*Wishing you and your  
family a  
happy and healthy  
holiday season*



## Recycle Your Holiday Lights

Did you find strings of holiday lights that are old or no longer working? Orange Village Service Department will accept them on December 6, 13, 20, 27, 2024 and January 3, 10 and 17, 2025 from 7:00 a.m. to 3:00 p.m. Drop off your old lights, power strips and power cords at the Orange Village Service Department Recycle Center, 4680 Lander Road, to be recycled.

## Habitat for Humanity ReStore Donations

Habitat for Humanity brings people together from all walks of life to build homes, communities and hope. With the help of donations made by generous individuals, businesses, contractors and homeowners, they can support their mission to rehab and build affordable homes for families.



Proceeds of every sale go to help families in Cuyahoga & Lorain County realize the dream of home-ownership. Your donations will be offered for sale to the public at ReStore locations; they will not be used in Habitat homes.

All items must be in good, clean, working, and sell-able condition. A few of the items that can be donated are listed below:

- Appliances - large and small (10 years old or newer)
- Household furniture
- Residential building supplies
- A full list of items can be found on their website at [ClevelandHabitat.org](http://ClevelandHabitat.org)

Items can be donated by dropping them off at a ReStore location (closest is North Randall, 4601 Northfield Road), during store hours or by calling 216-429-3631 to schedule a free pick-up.

## How to dispose of fire extinguishers



If you have an older fire extinguisher that is out of its service date (usually listed on the extinguisher), DO NOT throw it away even if they are plastic or metal. A fire extinguisher discarded in the garbage will pose a significant threat for workers in the event the unit gets compressed to the point of exploding.

Orange Village Fire Department is a collection point for old and outdated fire extinguishers. Simply bring your fire extinguisher to the fire department and we will take it from there. If you would like advice on the type of extinguisher to purchase and where to place it in the home, please contact Assistant Chief Larry Genova at 440-498-4402.

Visit our website at [www.orangevillage.com](http://www.orangevillage.com) for more information on recycling and other Village services.

# December 2024

ALL ACTIVITIES ARE LOCATED AT ORANGE VILLAGE HALL  
4600 LANDER ROAD, UNLESS OTHERWISE NOTED  
BD - Building Department and SD - Service Department  
located at 4680 Lander Rd.

| Sunday | Monday                           | Tuesday   | Wednesday  | Thursday  | Friday   | Saturday   |   |   |   |   |   |   |  |  |  |  |  |   |   |   |   |   |   |   |   |   |    |    |    |    |    |    |    |    |    |    |    |    |    |    |    |    |    |    |    |    |    |  |  |  |  |  |  |  |   |   |   |   |   |   |   |   |  |  |  |   |   |   |   |   |   |   |   |   |    |    |    |    |    |    |    |    |    |    |    |    |    |    |    |    |    |    |    |    |    |    |  |  |  |  |  |  |  |  |
|--------|----------------------------------|---|--|---|--|--|---|---|---|---|---|---|--|--|--|--|--|---|---|---|---|---|---|---|---|---|----|----|----|----|----|----|----|----|----|----|----|----|----|----|----|----|----|----|----|----|----|--|--|--|--|--|--|--|---|---|---|---|---|---|---|---|--|--|--|---|---|---|---|---|---|---|---|---|----|----|----|----|----|----|----|----|----|----|----|----|----|----|----|----|----|----|----|----|----|----|--|--|--|--|--|--|--|--|
| 1      | 2<br>Trash/Recycling<br>Pick up  | 3<br>Planning & Zoning<br>ABR Meeting - BD  | 4<br>Council Work<br>Session/Special<br>Meeting  | 5   | 6<br><br>Computer, Flags, Holiday<br>Lights & Household<br>Hazardous Waste<br>Collection<br>7 a.m. - 3 p.m. - SD  | 7<br> |   |   |   |   |   |   |  |  |  |  |  |   |   |   |   |   |   |   |   |   |    |    |    |    |    |    |    |    |    |    |    |    |    |    |    |    |    |    |    |    |    |  |  |  |  |  |  |  |   |   |   |   |   |   |   |   |  |  |  |   |   |   |   |   |   |   |   |   |    |    |    |    |    |    |    |    |    |    |    |    |    |    |    |    |    |    |    |    |    |    |  |  |  |  |  |  |  |  |
| 8      | 9<br>Trash/Recycling<br>Pick up  | 10  | 11<br>Finance Meeting<br>Council Meeting   | 12<br>Last Day<br>to Drop Off<br>Gifts for the Fire<br>Department's<br>Holiday Delivery<br>Service<br>(if not at capacity)  | 13<br>Holiday Lights<br>Collection<br>7 a.m.-3 p.m. - SD<br>Paper Shredding<br>Pepper Pike City<br>Hall, 28000 Shaker<br>9 a.m. - Noon   | 14   |   |   |   |   |   |   |  |  |  |  |  |   |   |   |   |   |   |   |   |   |    |    |    |    |    |    |    |    |    |    |    |    |    |    |    |    |    |    |    |    |    |  |  |  |  |  |  |  |   |   |   |   |   |   |   |   |  |  |  |   |   |   |   |   |   |   |   |   |    |    |    |    |    |    |    |    |    |    |    |    |    |    |    |    |    |    |    |    |    |    |  |  |  |  |  |  |  |  |
| 15     | 16<br>Trash/Recycling<br>Pick up | 17<br>Planning & Zoning<br>ABR Meeting - BD   | 18   | 19  | 20<br><br>Holiday Lights<br>Collection<br>7 a.m. - 3 p.m. - SD  | 21<br>Christmas<br>and<br>Hanukkah<br>Gift Delivery<br>1:00 pm<br>First Day of Winter    |   |   |   |   |   |   |  |  |  |  |  |   |   |   |   |   |   |   |   |   |    |    |    |    |    |    |    |    |    |    |    |    |    |    |    |    |    |    |    |    |    |  |  |  |  |  |  |  |   |   |   |   |   |   |   |   |  |  |  |   |   |   |   |   |   |   |   |   |    |    |    |    |    |    |    |    |    |    |    |    |    |    |    |    |    |    |    |    |    |    |  |  |  |  |  |  |  |  |
| 22     | 23<br>Trash/Recycling<br>Pick up | 24  | 25<br><br>Village Hall Closed<br>Hanukkah<br>Begins at Sundown | 26<br><br>Happy<br>Hanukkah<br> | 27<br><br>Holiday Lights<br>Collection<br>7 a.m. - 3 p.m. - SD  | 28   |   |   |   |   |   |   |  |  |  |  |  |   |   |   |   |   |   |   |   |   |    |    |    |    |    |    |    |    |    |    |    |    |    |    |    |    |    |    |    |    |    |  |  |  |  |  |  |  |   |   |   |   |   |   |   |   |  |  |  |   |   |   |   |   |   |   |   |   |    |    |    |    |    |    |    |    |    |    |    |    |    |    |    |    |    |    |    |    |    |    |  |  |  |  |  |  |  |  |
| 29     | 30<br>Trash/Recycling<br>Pick up | 31<br> |  |   | <div>November 2024</div> <table><tr><td>S</td><td>M</td><td>T</td><td>W</td><td>T</td><td>F</td><td>S</td></tr><tr><td></td><td></td><td></td><td></td><td></td><td>1</td><td>2</td></tr><tr><td>3</td><td>4</td><td>5</td><td>6</td><td>7</td><td>8</td><td>9</td></tr><tr><td>10</td><td>11</td><td>12</td><td>13</td><td>14</td><td>15</td><td>16</td></tr><tr><td>17</td><td>18</td><td>19</td><td>20</td><td>21</td><td>22</td><td>23</td></tr><tr><td>24</td><td>25</td><td>26</td><td>27</td><td>28</td><td>29</td><td>30</td></tr><tr><td></td><td></td><td></td><td></td><td></td><td></td><td></td></tr></table> | S  | M | T | W | T | F | S |  |  |  |  |  | 1 | 2 | 3 | 4 | 5 | 6 | 7 | 8 | 9 | 10 | 11 | 12 | 13 | 14 | 15 | 16 | 17 | 18 | 19 | 20 | 21 | 22 | 23 | 24 | 25 | 26 | 27 | 28 | 29 | 30 |  |  |  |  |  |  |  | <div>January 2025</div> <table><tr><td>S</td><td>M</td><td>T</td><td>W</td><td>T</td><td>F</td><td>S</td></tr><tr><td></td><td></td><td></td><td>1</td><td>2</td><td>3</td><td>4</td></tr><tr><td>5</td><td>6</td><td>7</td><td>8</td><td>9</td><td>10</td><td>11</td></tr><tr><td>12</td><td>13</td><td>14</td><td>15</td><td>16</td><td>17</td><td>18</td></tr><tr><td>19</td><td>20</td><td>21</td><td>22</td><td>23</td><td>24</td><td>25</td></tr><tr><td>26</td><td>27</td><td>28</td><td>29</td><td>30</td><td>31</td><td></td></tr><tr><td></td><td></td><td></td><td></td><td></td><td></td><td></td></tr></table> | S | M | T | W | T | F | S |  |  |  | 1 | 2 | 3 | 4 | 5 | 6 | 7 | 8 | 9 | 10 | 11 | 12 | 13 | 14 | 15 | 16 | 17 | 18 | 19 | 20 | 21 | 22 | 23 | 24 | 25 | 26 | 27 | 28 | 29 | 30 | 31 |  |  |  |  |  |  |  |  |
| S      | M                                | T   | W  | T   | F  | S  |   |   |   |   |   |   |  |  |  |  |  |   |   |   |   |   |   |   |   |   |    |    |    |    |    |    |    |    |    |    |    |    |    |    |    |    |    |    |    |    |    |  |  |  |  |  |  |  |   |   |   |   |   |   |   |   |  |  |  |   |   |   |   |   |   |   |   |   |    |    |    |    |    |    |    |    |    |    |    |    |    |    |    |    |    |    |    |    |    |    |  |  |  |  |  |  |  |  |
|        |                                  |   |  |   | 1  | 2  |   |   |   |   |   |   |  |  |  |  |  |   |   |   |   |   |   |   |   |   |    |    |    |    |    |    |    |    |    |    |    |    |    |    |    |    |    |    |    |    |    |  |  |  |  |  |  |  |   |   |   |   |   |   |   |   |  |  |  |   |   |   |   |   |   |   |   |   |    |    |    |    |    |    |    |    |    |    |    |    |    |    |    |    |    |    |    |    |    |    |  |  |  |  |  |  |  |  |
| 3      | 4                                | 5   | 6  | 7   | 8  | 9  |   |   |   |   |   |   |  |  |  |  |  |   |   |   |   |   |   |   |   |   |    |    |    |    |    |    |    |    |    |    |    |    |    |    |    |    |    |    |    |    |    |  |  |  |  |  |  |  |   |   |   |   |   |   |   |   |  |  |  |   |   |   |   |   |   |   |   |   |    |    |    |    |    |    |    |    |    |    |    |    |    |    |    |    |    |    |    |    |    |    |  |  |  |  |  |  |  |  |
| 10     | 11                               | 12  | 13   | 14  | 15   | 16   |   |   |   |   |   |   |  |  |  |  |  |   |   |   |   |   |   |   |   |   |    |    |    |    |    |    |    |    |    |    |    |    |    |    |    |    |    |    |    |    |    |  |  |  |  |  |  |  |   |   |   |   |   |   |   |   |  |  |  |   |   |   |   |   |   |   |   |   |    |    |    |    |    |    |    |    |    |    |    |    |    |    |    |    |    |    |    |    |    |    |  |  |  |  |  |  |  |  |
| 17     | 18                               | 19  | 20   | 21  | 22   | 23   |   |   |   |   |   |   |  |  |  |  |  |   |   |   |   |   |   |   |   |   |    |    |    |    |    |    |    |    |    |    |    |    |    |    |    |    |    |    |    |    |    |  |  |  |  |  |  |  |   |   |   |   |   |   |   |   |  |  |  |   |   |   |   |   |   |   |   |   |    |    |    |    |    |    |    |    |    |    |    |    |    |    |    |    |    |    |    |    |    |    |  |  |  |  |  |  |  |  |
| 24     | 25                               | 26  | 27   | 28  | 29   | 30   |   |   |   |   |   |   |  |  |  |  |  |   |   |   |   |   |   |   |   |   |    |    |    |    |    |    |    |    |    |    |    |    |    |    |    |    |    |    |    |    |    |  |  |  |  |  |  |  |   |   |   |   |   |   |   |   |  |  |  |   |   |   |   |   |   |   |   |   |    |    |    |    |    |    |    |    |    |    |    |    |    |    |    |    |    |    |    |    |    |    |  |  |  |  |  |  |  |  |
|        |                                  |   |  |   |  |  |   |   |   |   |   |   |  |  |  |  |  |   |   |   |   |   |   |   |   |   |    |    |    |    |    |    |    |    |    |    |    |    |    |    |    |    |    |    |    |    |    |  |  |  |  |  |  |  |   |   |   |   |   |   |   |   |  |  |  |   |   |   |   |   |   |   |   |   |    |    |    |    |    |    |    |    |    |    |    |    |    |    |    |    |    |    |    |    |    |    |  |  |  |  |  |  |  |  |
| S      | M                                | T   | W  | T   | F  | S  |   |   |   |   |   |   |  |  |  |  |  |   |   |   |   |   |   |   |   |   |    |    |    |    |    |    |    |    |    |    |    |    |    |    |    |    |    |    |    |    |    |  |  |  |  |  |  |  |   |   |   |   |   |   |   |   |  |  |  |   |   |   |   |   |   |   |   |   |    |    |    |    |    |    |    |    |    |    |    |    |    |    |    |    |    |    |    |    |    |    |  |  |  |  |  |  |  |  |
|        |                                  |   | 1  | 2   | 3  | 4  |   |   |   |   |   |   |  |  |  |  |  |   |   |   |   |   |   |   |   |   |    |    |    |    |    |    |    |    |    |    |    |    |    |    |    |    |    |    |    |    |    |  |  |  |  |  |  |  |   |   |   |   |   |   |   |   |  |  |  |   |   |   |   |   |   |   |   |   |    |    |    |    |    |    |    |    |    |    |    |    |    |    |    |    |    |    |    |    |    |    |  |  |  |  |  |  |  |  |
| 5      | 6                                | 7   | 8  | 9   | 10   | 11   |   |   |   |   |   |   |  |  |  |  |  |   |   |   |   |   |   |   |   |   |    |    |    |    |    |    |    |    |    |    |    |    |    |    |    |    |    |    |    |    |    |  |  |  |  |  |  |  |   |   |   |   |   |   |   |   |  |  |  |   |   |   |   |   |   |   |   |   |    |    |    |    |    |    |    |    |    |    |    |    |    |    |    |    |    |    |    |    |    |    |  |  |  |  |  |  |  |  |
| 12     | 13                               | 14  | 15   | 16  | 17   | 18   |   |   |   |   |   |   |  |  |  |  |  |   |   |   |   |   |   |   |   |   |    |    |    |    |    |    |    |    |    |    |    |    |    |    |    |    |    |    |    |    |    |  |  |  |  |  |  |  |   |   |   |   |   |   |   |   |  |  |  |   |   |   |   |   |   |   |   |   |    |    |    |    |    |    |    |    |    |    |    |    |    |    |    |    |    |    |    |    |    |    |  |  |  |  |  |  |  |  |
| 19     | 20                               | 21  | 22   | 23  | 24   | 25   |   |   |   |   |   |   |  |  |  |  |  |   |   |   |   |   |   |   |   |   |    |    |    |    |    |    |    |    |    |    |    |    |    |    |    |    |    |    |    |    |    |  |  |  |  |  |  |  |   |   |   |   |   |   |   |   |  |  |  |   |   |   |   |   |   |   |   |   |    |    |    |    |    |    |    |    |    |    |    |    |    |    |    |    |    |    |    |    |    |    |  |  |  |  |  |  |  |  |
| 26     | 27                               | 28  | 29   | 30  | 31   |  |   |   |   |   |   |   |  |  |  |  |  |   |   |   |   |   |   |   |   |   |    |    |    |    |    |    |    |    |    |    |    |    |    |    |    |    |    |    |    |    |    |  |  |  |  |  |  |  |   |   |   |   |   |   |   |   |  |  |  |   |   |   |   |   |   |   |   |   |    |    |    |    |    |    |    |    |    |    |    |    |    |    |    |    |    |    |    |    |    |    |  |  |  |  |  |  |  |  |
|        |                                  |   |  |   |  |  |   |   |   |   |   |   |  |  |  |  |  |   |   |   |   |   |   |   |   |   |    |    |    |    |    |    |    |    |    |    |    |    |    |    |    |    |    |    |    |    |    |  |  |  |  |  |  |  |   |   |   |   |   |   |   |   |  |  |  |   |   |   |   |   |   |   |   |   |    |    |    |    |    |    |    |    |    |    |    |    |    |    |    |    |    |    |    |    |    |    |  |  |  |  |  |  |  |  |

## Tips to Stop Unwanted Robocalls and Avoid Phone Scams

Source: Federal Communications Commission ([www.fcc.org](http://www.fcc.org))

Unwanted calls – including illegal and spoofed robocalls - are the FCC's top consumer complaint and top consumer protection priority. Robocalls and texts can be annoying, frustrating and - EVEN WORSE - FRAUDULENT. The FCC is committed to protecting you from illegal robocalls, texts and caller ID spoofing. Below are a few tips to assist you with unwanted robocalls and avoid phone scams:

- ① Put your mobile and landline numbers on the national Do Not Call Registry. Visit [donotcall.gov](http://donotcall.gov) or call 1-888-382-1222 from the number you want to register.
- ① Don't answer calls from unknown numbers. If you answer such a call, hang up immediately. Never call back an unfamiliar number – it may lead to a scam.
- ① If you answer the phone and the caller - or a recording - asks you to hit a button to stop getting the calls, you should just hang up. Scammers often use this trick to identify potential targets.
- ① Do not respond to any questions, especially those that can be answered with "Yes."
- ① Spoofed caller ID numbers may trick you into answering. If you answer a spoofed call, hang up immediately. Do not respond to even simple questions or requests.
- ① Scam callers may pretend to represent an organization, business or even a government agency. **Never reveal any personal or financial information unless you can independently verify the caller.**
- ① Research apps, services or devices that help block unwanted calls
- ① FCC rules offer protection against unwanted calls and texts. File a complaint with the FCC to help them determine where to take action. Visit [consumercomplaints.fcc.gov](http://consumercomplaints.fcc.gov).



Find web resources and learn more at [www.fcc.gov/robocalls](http://www.fcc.gov/robocalls).

# 2025

| January |    |    |    |    |    |    |
|---------|----|----|----|----|----|----|
| S       | M  | T  | W  | T  | F  | S  |
|         |    |    | 1  | 2  | 3  | 4  |
| 5       | 6  | 7  | 8  | 9  | 10 | 11 |
| 12      | 13 | 14 | 15 | 16 | 17 | 18 |
| 19      | 20 | 21 | 22 | 23 | 24 | 25 |
| 26      | 27 | 28 | 29 | 30 | 31 |    |

| February |    |    |    |    |    |    |
|----------|----|----|----|----|----|----|
| S        | M  | T  | W  | T  | F  | S  |
|          |    |    |    |    |    | 1  |
| 2        | 3  | 4  | 5  | 6  | 7  | 8  |
| 9        | 10 | 11 | 12 | 13 | 14 | 15 |
| 16       | 17 | 18 | 19 | 20 | 21 | 22 |
| 23       | 24 | 25 | 26 | 27 | 28 |    |

| March |    |    |    |    |    |    |
|-------|----|----|----|----|----|----|
| S     | M  | T  | W  | T  | F  | S  |
|       |    |    |    |    |    | 1  |
| 2     | 3  | 4  | 5  | 6  | 7  | 8  |
| 9     | 10 | 11 | 12 | 13 | 14 | 15 |
| 16    | 17 | 18 | 19 | 20 | 21 | 22 |
| 23    | 24 | 25 | 26 | 27 | 28 | 29 |
| 30    | 31 |    |    |    |    |    |

| April |    |    |    |    |    |    |
|-------|----|----|----|----|----|----|
| S     | M  | T  | W  | T  | F  | S  |
|       |    | 1  | 2  | 3  | 4  | 5  |
| 6     | 7  | 8  | 9  | 10 | 11 | 12 |
| 13    | 14 | 15 | 16 | 17 | 18 | 19 |
| 20    | 21 | 22 | 23 | 24 | 25 | 26 |
| 27    | 28 | 29 | 30 |    |    |    |

| May |    |    |    |    |    |    |
|-----|----|----|----|----|----|----|
| S   | M  | T  | W  | T  | F  | S  |
|     |    |    |    | 1  | 2  | 3  |
| 4   | 5  | 6  | 7  | 8  | 9  | 10 |
| 11  | 12 | 13 | 14 | 15 | 16 | 17 |
| 18  | 19 | 20 | 21 | 22 | 23 | 24 |
| 25  | 26 | 27 | 28 | 29 | 30 | 31 |

| June |    |    |    |    |    |    |
|------|----|----|----|----|----|----|
| S    | M  | T  | W  | T  | F  | S  |
| 1    | 2  | 3  | 4  | 5  | 6  | 7  |
| 8    | 9  | 10 | 11 | 12 | 13 | 14 |
| 15   | 16 | 17 | 18 | 19 | 20 | 21 |
| 22   | 23 | 24 | 25 | 26 | 27 | 28 |
| 29   | 30 |    |    |    |    |    |

| July |    |    |    |    |    |    |
|------|----|----|----|----|----|----|
| S    | M  | T  | W  | T  | F  | S  |
|      |    | 1  | 2  | 3  | 4  | 5  |
| 6    | 7  | 8  | 9  | 10 | 11 | 12 |
| 13   | 14 | 15 | 16 | 17 | 18 | 19 |
| 20   | 21 | 22 | 23 | 24 | 25 | 26 |
| 27   | 28 | 29 | 30 | 31 |    |    |

| August |    |    |    |    |    |    |
|--------|----|----|----|----|----|----|
| S      | M  | T  | W  | T  | F  | S  |
|        |    |    |    |    | 1  | 2  |
| 3      | 4  | 5  | 6  | 7  | 8  | 9  |
| 10     | 11 | 12 | 13 | 14 | 15 | 16 |
| 17     | 18 | 19 | 20 | 21 | 22 | 23 |
| 24     | 25 | 26 | 27 | 28 | 29 | 30 |
| 31     |    |    |    |    |    |    |

| September |    |    |    |    |    |    |
|-----------|----|----|----|----|----|----|
| S         | M  | T  | W  | T  | F  | S  |
|           | 1  | 2  | 3  | 4  | 5  | 6  |
| 7         | 8  | 9  | 10 | 11 | 12 | 13 |
| 14        | 15 | 16 | 17 | 18 | 19 | 20 |
| 21        | 22 | 23 | 24 | 25 | 26 | 27 |
| 28        | 29 | 30 |    |    |    |    |

| October |    |    |    |    |    |    |
|---------|----|----|----|----|----|----|
| S       | M  | T  | W  | T  | F  | S  |
|         |    |    | 1  | 2  | 3  | 4  |
| 5       | 6  | 7  | 8  | 9  | 10 | 11 |
| 12      | 13 | 14 | 15 | 16 | 17 | 18 |
| 19      | 20 | 21 | 22 | 23 | 24 | 25 |
| 26      | 27 | 28 | 29 | 30 | 31 |    |

| November |    |    |    |    |    |    |
|----------|----|----|----|----|----|----|
| S        | M  | T  | W  | T  | F  | S  |
|          |    |    |    |    |    | 1  |
| 2        | 3  | 4  | 5  | 6  | 7  | 8  |
| 9        | 10 | 11 | 12 | 13 | 14 | 15 |
| 16       | 17 | 18 | 19 | 20 | 21 | 22 |
| 23       | 24 | 25 | 26 | 27 | 28 | 29 |
| 30       |    |    |    |    |    |    |

| December |    |    |    |    |    |    |
|----------|----|----|----|----|----|----|
| S        | M  | T  | W  | T  | F  | S  |
|          | 1  | 2  | 3  | 4  | 5  | 6  |
| 7        | 8  | 9  | 10 | 11 | 12 | 13 |
| 14       | 15 | 16 | 17 | 18 | 19 | 20 |
| 21       | 22 | 23 | 24 | 25 | 26 | 27 |
| 28       | 29 | 30 | 31 |    |    |    |

## Important Phone Numbers

| Name                    | Number       |
|-------------------------|--------------|
| Child Abuse Hotline     | 216-696-5437 |
| Poison Control          | 800-222-1222 |
| Suicide/Crisis Lifeline | 988          |
|                         |              |
|                         |              |
|                         |              |
|                         |              |
|                         |              |
|                         |              |
|                         |              |
|                         |              |
|                         |              |
|                         |              |
|                         |              |
|                         |              |
|                         |              |
|                         |              |
|                         |              |
|                         |              |

## Community Phone Numbers

| Name   | Number              |
|--|---------------------|
| Cleveland Division of Water - Emergency Line       | 216-664-3060        |
| Cleveland Division of Water                        | 216-664-3130        |
| Cuyahoga County Board of Elections                 | 216-443-8683        |
| Cuyahoga County Board of Health                    | 216-201-2000        |
| Cuyahoga County Public Library - Orange Branch     | 216-831-4282        |
| Cuyahoga County Solid Waste District               | 216-443-3749        |
| Dominion East Ohio Gas                             | 800-362-7557        |
| Kimble Refuse (trash collection)                   | 800-201-0005        |
| The Illuminating Co./ FirstEnergy                  | 800-633-4766        |
| The Illuminating Co.- Report Lights Out/Flickering | 888-544-4877        |
| NOPEC  | 855-667-3201        |
| Northeast Ohio Regional Sewer District             | 216-641-6000        |
| Orange Board of Education                          | 216-831-8600        |
| Orange Recreation                                  | 216-831-8601        |
| Orange Senior Center                               | 216-831-8601 x 5700 |
| Woodbran Sewer                                     | 216-831-9110        |

Don't miss out -- Important information is sent bi-monthly in our Orange Village e-newsletter. Sign up at [www.OrangeVillage.com](http://www.OrangeVillage.com)

# CALENDAR INDEX

## DESCRIPTION

## MONTH

### Branch and Leaf Collection

|   |         |
|---|---------|
| Branch and Brush Collection .....             | April   |
| Leaf Collection .....                         | October |
| Leaf Humus- Delivered to your home FREE ..... | March   |
| Woodchips - Delivered to your home FREE ..... | April   |

### Disposal of Items

|   |           |
|---|-----------|
| CFL Bulbs and Fluorescent Tubes .....         | August    |
| Fire Extinguishers .....                      | December  |
| Fryer Oil Disposal .....                      | November  |
| Latex Paint - How to Dispose of .....         | June      |
| Miscellaneous Items for CURBSIDE Pickup ..... | May       |
| Televisions .....                             | February  |
| Vehicle Batteries .....                       | September |

### Events

|   |                       |
|---|-----------------------|
| Garage Sale - Community Wide .....            | June                  |
| Holiday Gift Delivery - Fire Department ..... | November and December |
| Party in the Park .....                       | July                  |

### Recycling

|   |                      |
|---|----------------------|
| Batteries, Writing Tools and More ..... | February             |
| Campaign Signs .....                    | November             |
| Cans for Burned Children .....          | July                 |
| Computer/Escrap Recycling .....         | April                |
| ENERGY STAR® .....                      | May                  |
| Flag Disposal .....                     | June                 |
| Holiday Light Recycling .....           | January and December |
| Holiday Tree Recycling .....            | January              |
| Household Hazardous Waste .....         | January              |
| Medicine Disposal .....                 | July                 |
| Paper Shredding .....                   | February             |
| Scrap Tire Collection .....             | September            |

### Miscellaneous

|                                       |            |
|---------------------------------------|------------|
| Donate to Kiwanis .....               | June       |
| How Long Does it Last? .....          | October    |
| Services Offered to Residents .....   | Front Page |
| Smoke/Carbon Monoxide Detectors ..... | March      |



Printed on  
Recycled  
Paper



Grant funding provided by:



**Cuyahoga County**  
SOLID WASTE DISTRICT  
[CuyahogaRecycles.org](http://CuyahogaRecycles.org)